

Bill of Materials Listing

TransArctic Canada Inc.

11/5/2012
Page 1 of 1

Product Number	Description	Date	Weight	Uof M	Yield
Line Component Prod#	Description	Bin Unit	Qty		
KMC83991	Mt Kit, HDX, ISC, 4xFC,2B/2A,8" Crank,'12		9/12/2012	149.95	0
10	PAC23150	Pack, Carton, 23" x 15" x 10", 51 ECT	each	1	
15	BEL22007	Belt, B gr, 2007mm (79") (258-079)	each	2	
20	KBB00001	Mt Kit, Platform, Transit, ADM, '12	each	1	
30	KCB03901	Mt Kit, Comp, 4xFC, '12	each	1	
40	KFT00001	Kit, Found'n, HDX, 4xFC, '12	each	1	
50	KPC83004	Kit, Pulley, ISC, 2A/2B, HDX, '12	each	1	

Bill of Materials Listing

TransArctic Canada Inc.

12/5/2012
Page 1 of 1

Product Number	Description	Date	Weight	Uof M	Yield
Line	Component Prod#	Bin	Unit	Qty	
KBB00001	Mt Kit, Platform, Transit, ADM, '12		6/20/2012	76.18	0
10	BMZ01034		Bkt, Spring, Support Arm, ADM, '12	each	1
20	BMZ01035		Bkt, Main, Pivot, Ass'y, ADM Transit,'12	each	1
30	BMZ01037		Bkt, Fork, Knuckle-Joint, Adm, '12	each	1
40	BMZ01038		Bkt, Main, Base Pl, ADM, '12	each	1
50	BMZ01040		Bkt, Ass'y, THRD Rod, Isolator, ADM, '12	each	1
60	BMZ01041		Shaft Key, 8mm W x7mm H x13.7mm Long	each	2
70	BMZ01042		Vibration Isolator, Bar, 9.63 x 2 x 1.50	each	2
80	BMZ01044		Bkt, Cradle, Pivot, Adm Transit, '12	each	1
90	BMZ01047		Bkt, Bar, Slide Nut, ADJ, Trans ADM, '12	each	2
100	BTS08100		Bolt, Grease,Nipple,1/2-13 x 1.0"	each	1
105	FTS04007		Ftg, Grease, Nipple, 1/4-28 UNF-2A,Brass	each	1
110	PIS01010		Shaft, Stl, Grease, ADM Transit, '12	each	1
120	SPR00002		Spring, Comp, R/H, 110 x 50 x 8.4, Red	each	1
130	WFS16001		Washer, Flat, Dbl Step, 17mm, 50mm, Plt	each	1
140	WFS27001		Washer, Flat, Dbl Step, 27mm, 63.5, Plt	each	1
150	KBB00025		Bag Kit, Fasteners, KBB00001	each	1

Bill of Materials Listing

TransArctic Canada Inc.

12/5/2012
Page 1 of 1

Product Number	Description	Date	Weight	Uof M	Yield
Line Component Prod# Description	Bin	Unit	Qty		
KBB00025	Bag Kit, Fasteners, KBB00001	8/1/2012	3.90		0
10 BTQ08126	Bolt, Hex, 1/2-20unf, 1.25", 8, Plt	each	12		
15 BTQ08100	Bolt, Hex, 1/2-13unc, 1.00", 8, Plt	each	1		
20 BTQ08150	Bolt, Hex, 1/2-13unc, 1.5", 8, Plt	each	9		
30 BTQ10351	Bolt, Hex, 5/8-18unf, 3.5", 8, PLT	each	1		
50 NTQ08000	Nut, Hex, 1/2-13unc, 8, Plt	each	5		
60 NTQ10000	Nut, Hex, 5/8-11unc, 8, Plt	each	2		
65 NTQ10001	Nut, Hex, 5/8-18unf, 8, Plt	each	1		
70 WFS08001	Washer, Flat, 1/2", 8, USS, Plt	each	2		
100 WFQ08000	Washer, Flat, 1/2", 8, Plt	each	14		
110 WFQ10000	Washer, Flat, 5/8", 8, Plt	each	2		
120 WLQ08000	Washer, Lock, 1/2", 8, Plt	each	23		
130 WLQ10000	Washer, Lock, 5/8", 8, Plt	each	2		

Bill of Materials Listing

TransArctic Canada Inc.

11/5/2012
Page 1 of 1

Product Number	Description	Date	Weight	Uof M	Yield
Line Component Prod# Description	Bin	Unit	Qty		
KCB03901	Mt Kit, Comp, 4xFC, '12	10/2/2012	0.99		0
10 BTQ08250	Bolt, Hex, 1/2-13unc, 2.5", 8, Plt	each	4		
20 NTQ08000	Nut, Hex, 1/2-13unc, 8, Plt	each	4		
30 WFQ08000	Washer, Flat, 1/2", 8, Plt	each	4		
40 WLQ08000	Washer, Lock, 1/2", 8, Plt	each	4		

Bill of Materials Listing

TransArctic Canada Inc.

11/5/2012
Page 1 of 1

Product Number		Description	Bin	Date	Weight	Uof M	Yield
Line	Component Prod#	Description		Unit	Qty		
KFT00001		Kit, Found'n, HDX, 4xFC, '12		8/20/2012	46.76		0
10	BMZ01053	Bkt, Weldm't, Platform box,HDX, ISC, '12		each	1		
20	BMZ01058	Bkt, Knuckle-Joint, Support,TH, HDX, '12		each	1		
30	BMZ01059	Bkt, Slide, Block, TH, HDX, '12		each	1		
40	BMZ01061	Bkt, Adapter, Spacer PI, TH, HDX, '12		each	2		
50	KTT00002	Kit, Tensioner Bracket,Ass'y,TH,HDX, '12		each	1		
60	KBT00003	Bag Kit, Fasteners, KFT00001		each	1		

Bill of Materials Listing

TransArctic Canada Inc.

11/5/2012
Page 1 of 1

Product Number	Description	Date	Weight	Uof M	Yield
Line Component Prod# Description	Bin	Unit	Qty		
KBT00003	Bag Kit, Fasteners, KFT00001	10/25/2012	1.10		0
10 BTQ06175	Bolt, Hex, 3/8-16unc, 1.75", 8, Plt	each	9		
20 NTQ06000	Nut, Hex, 3/8-16unc, 8, Plt	each	9		
30 WFN06000	Washer, Flat, 3/8", 2, Plt	each	18		
40 WLQ06000	Washer, Lock, 3/8", 8, Plt	each	9		

Bill of Materials Listing

TransArctic Canada Inc.

11/5/2012
Page 1 of 1

Product Number	Description	Date	Weight	Uof M	Yield
Line Component Prod#	Description	Bin Unit	Qty		
KPC83004	Kit, Pulley, ISC, 2A/2B, HDX, '12		10/19/2007	17.34	0
10	PUL83004		Pulley, Crank, ISC, 8.3L, 2B/X, 8", '08	each	1
20	BTC12060		Bolt, Hex, 12 x 1.75 x 60mm, 10.9,Plt,FT	each	4

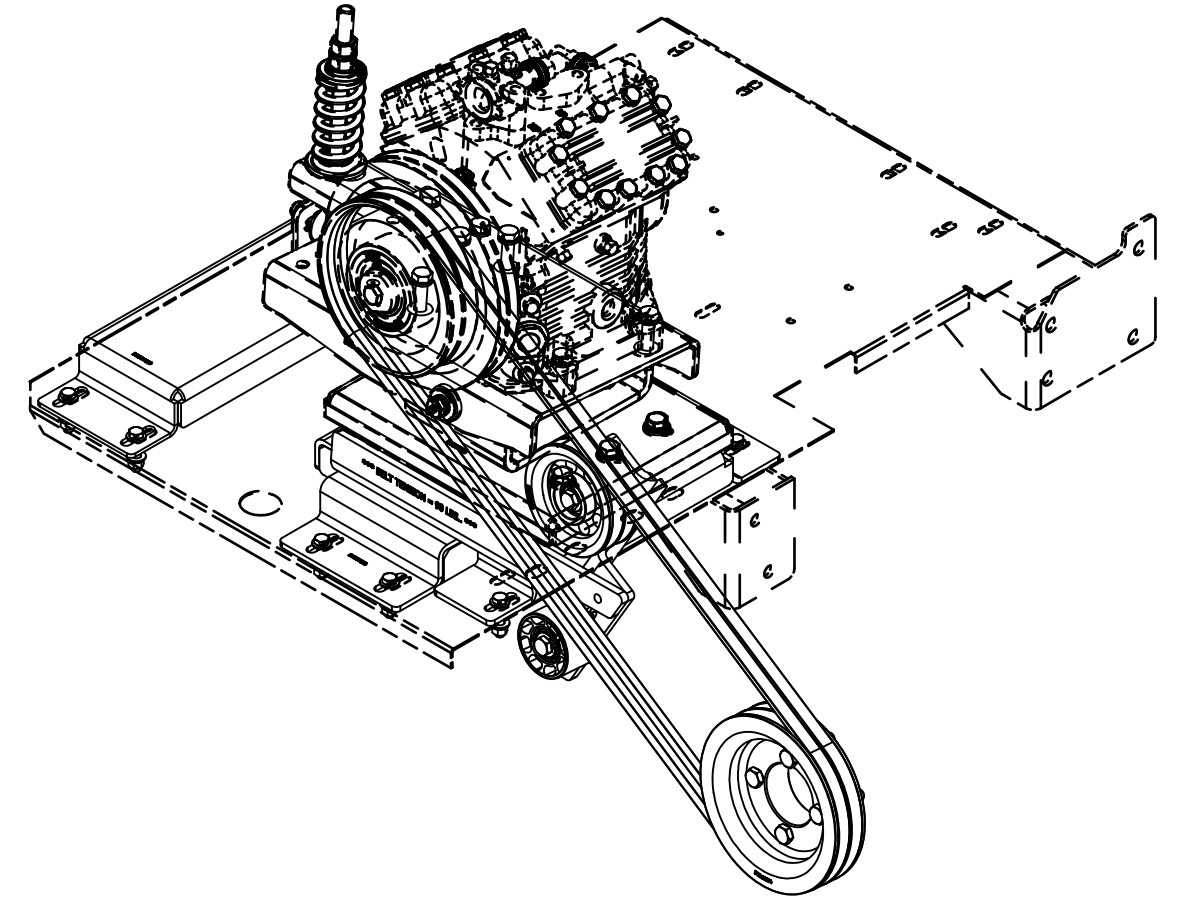
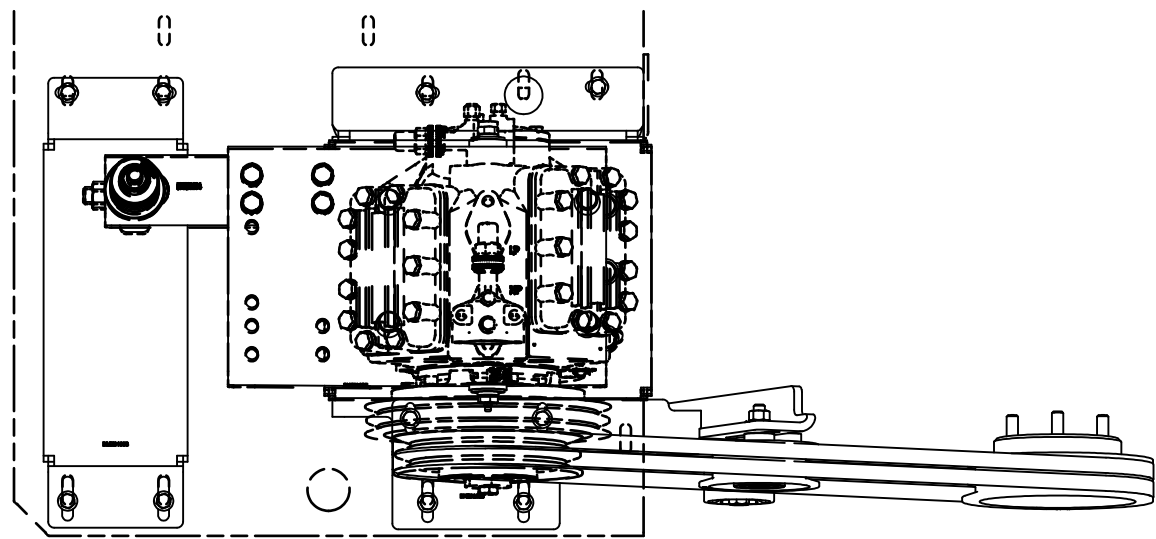

ISOMETRIC VIEW

NOTE:
SHOWING COMPRESSOR
4xFCY OR
FK40 xxx
AS REFERANCE.

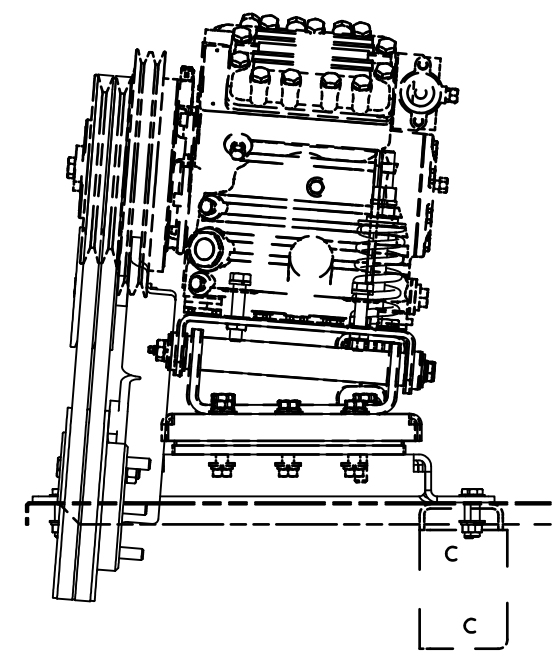
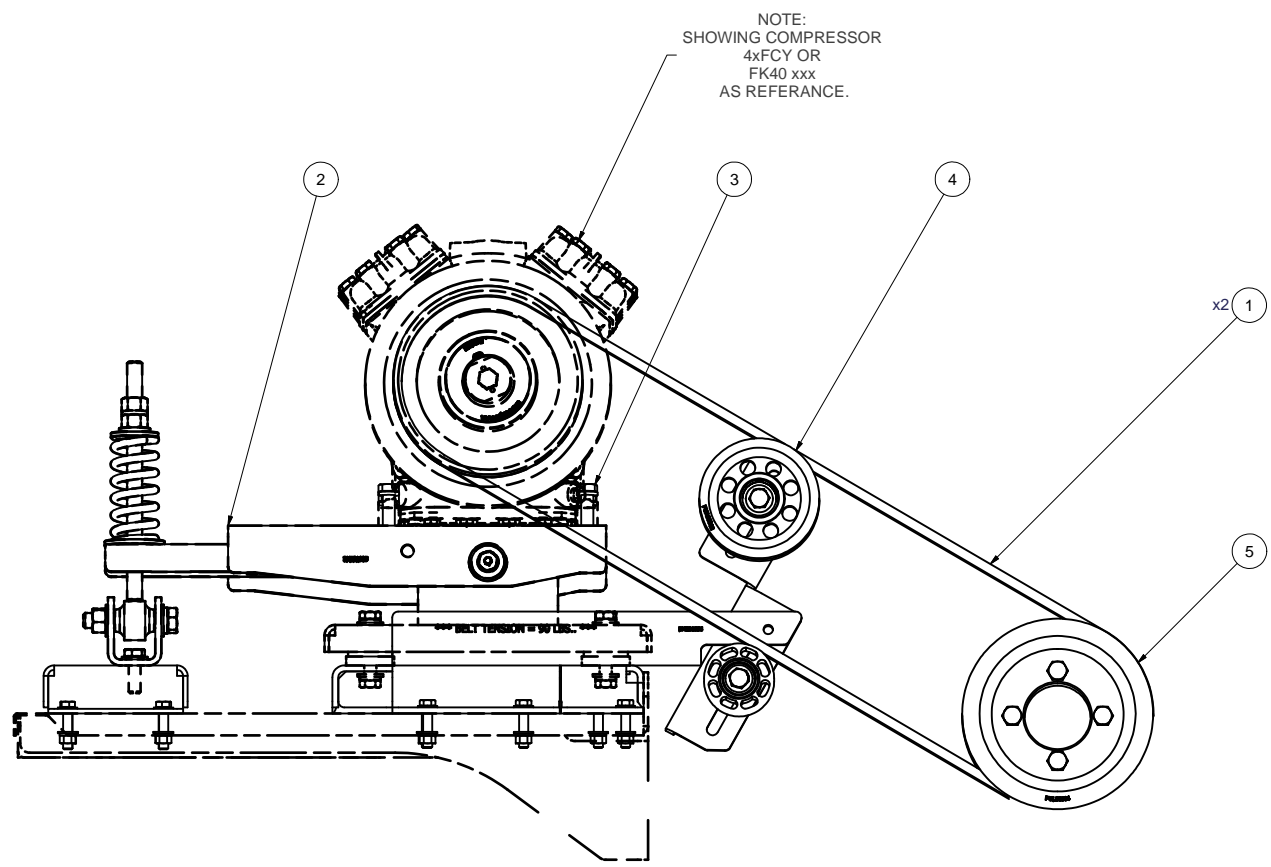

NOTES:
1) USE SERVICABLE THREADLOCKER ON ALL FASTENERS TO ENGINE COMPONENTS AND TORQUE ALL BOLTS TO S.A.E. SPECIFICATIONS.
2) SEE "TRANSARCTIC A/C COMPRESSOR MOUNT INSTALLATION DISCLAIMER".

ITEM	QTY	U/M	PART NUMBER	DESCRIPTION
5	1	EACH	KPC83004	KIT, PULLEY, ISC, 2A/2B, HDX, '12
4	1	EACH	KFT00001	KIT, FOUND'N, HDX, 4xFC, '12
3	1	EACH	KCB03901	MT KIT, COMP, 4xFC, '12
2	1	EACH	KBB00001	MT KIT, PLATFORM, TRANSIT, ADM, '12
1	2	EACH	BEL22007	BELT, B GR, 2007mm (79") (258-079)

BILL OF MATERIALS				
DRAWN	jrodriguez	11/5/2012	TRANSARCTIC INC. TITLE MT KIT, HDX, ISC, 4xFC, 2B/2A, 8" CRANK, '12	
CHECKED	Val Jakowlew	11/5/2012		
REV	ECN	DESCRIPTION		DATE
0		RELEASED TO PRODUCTION		11/5/2012
BY:	James Stewart	11/5/2012		
MFG	Ron Ingram	11/5/2012		
APPROVED	Dale Mason	11/5/2012		
SIZE	D	DWG NO	KMC83991	
SCALE	1:2	REV	0	

UNSPECIFIED TOLERANCES:	[ALT. DIM.]
ONE DECIMAL PLACE (X)	50 [0.005]
TWO DECIMAL PLACE (XX)	25 [0.010]
THREE DECIMAL PLACE (XXX)	10 [0.005]
FRACTIONAL (1/32")	ANGULAR +/- .50°



THIRD ANGLE PROJECTION

DRAWING UNIT OF MEASURE: MM [INCH] SCALE: 1:2 SHEET 1 OF 1

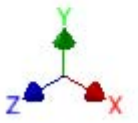
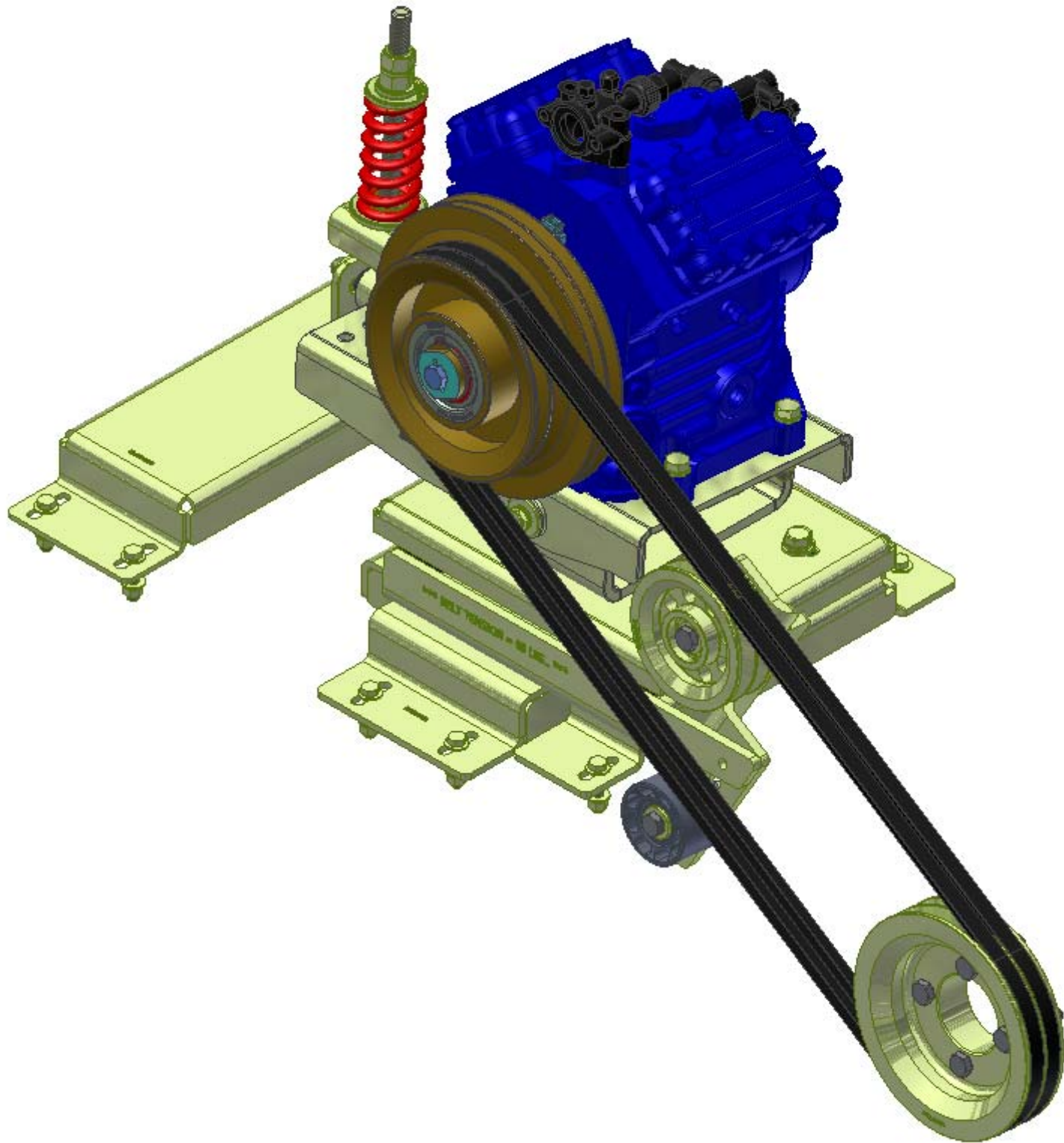

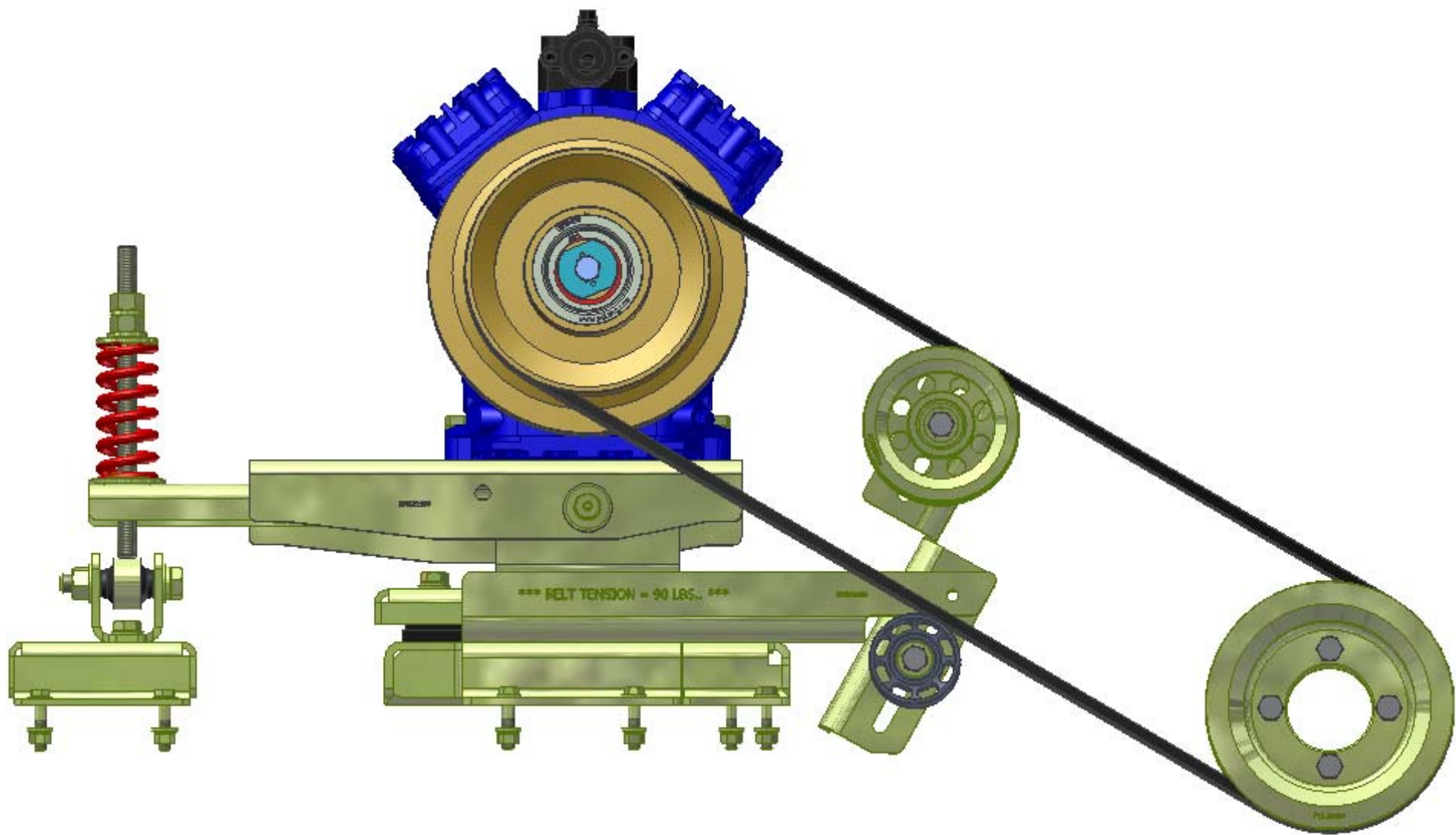

*** BELT TENSION = 90 LBS. ***

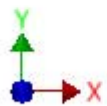

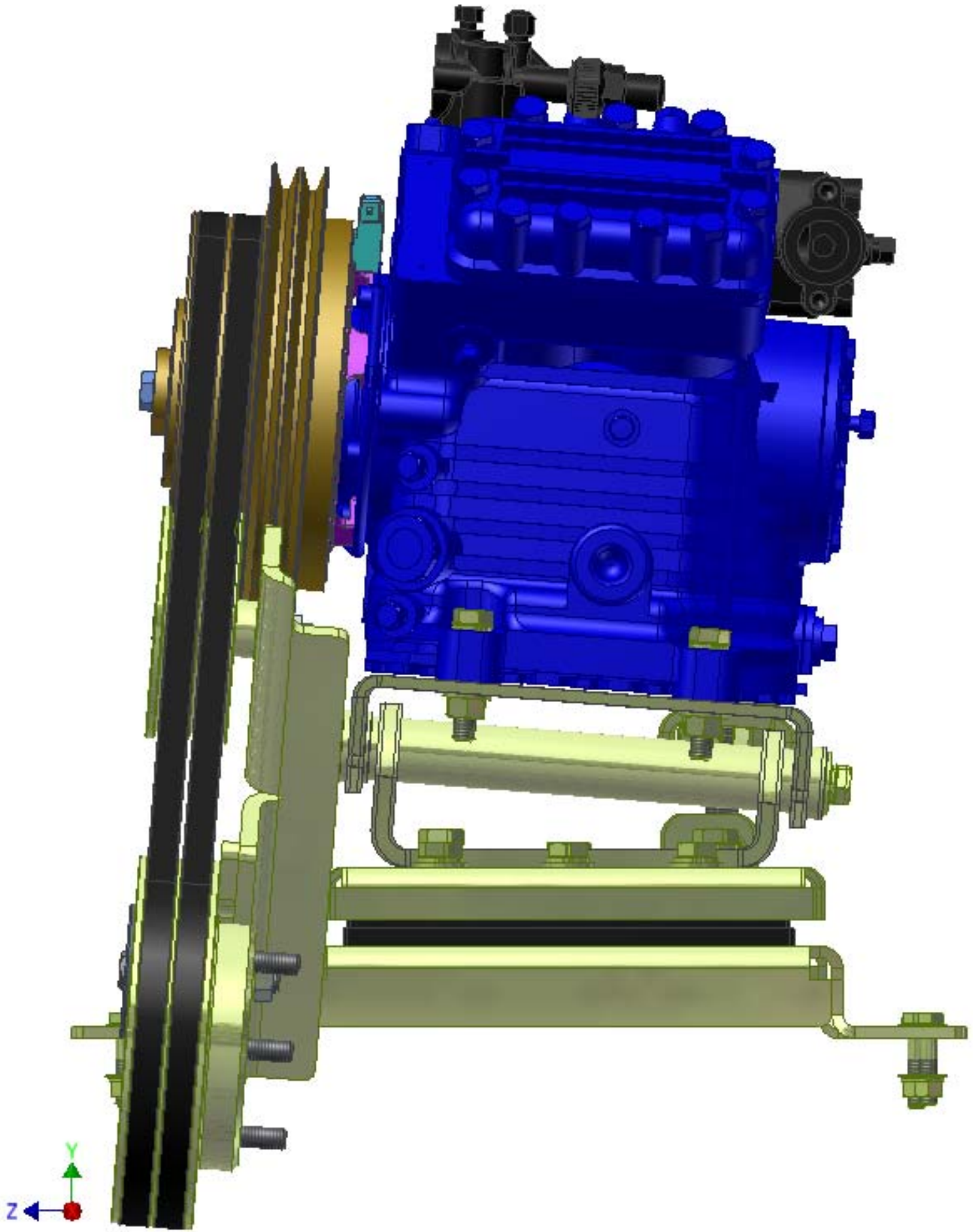

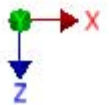
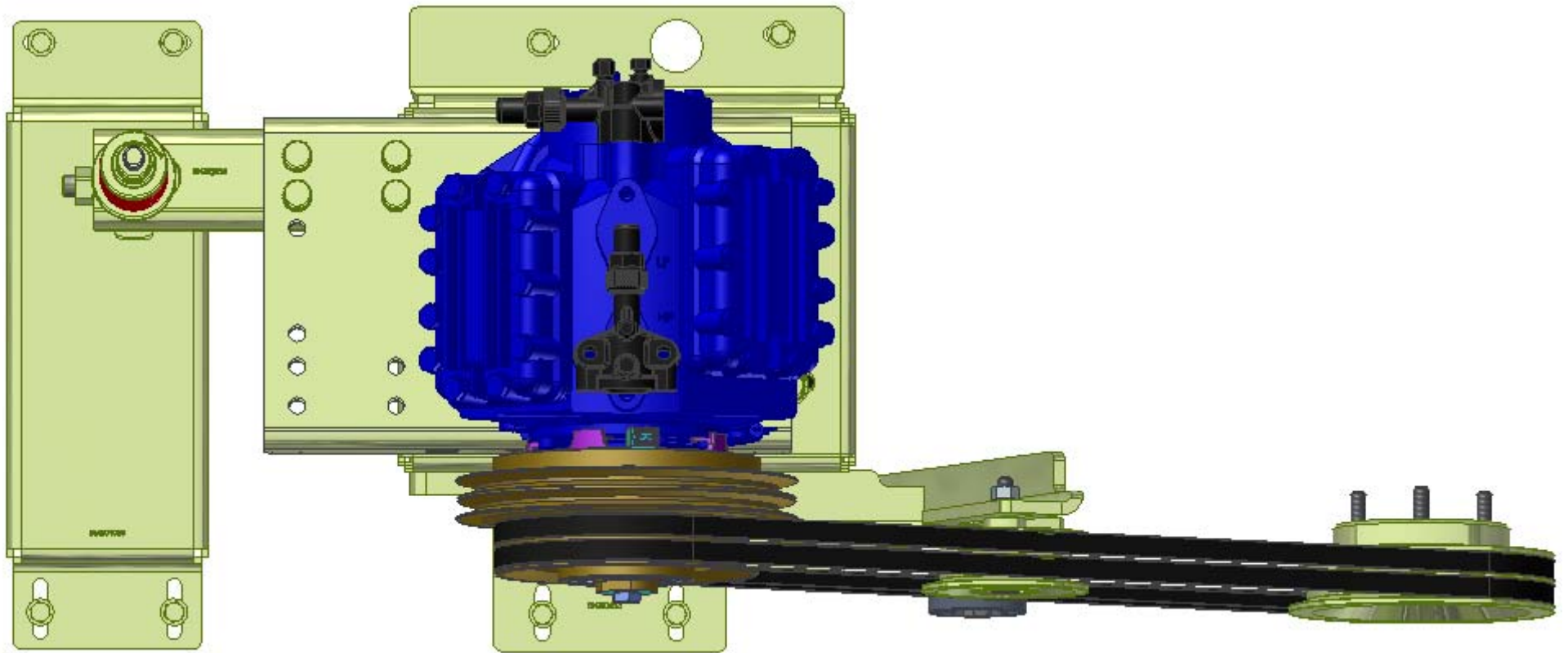

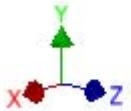
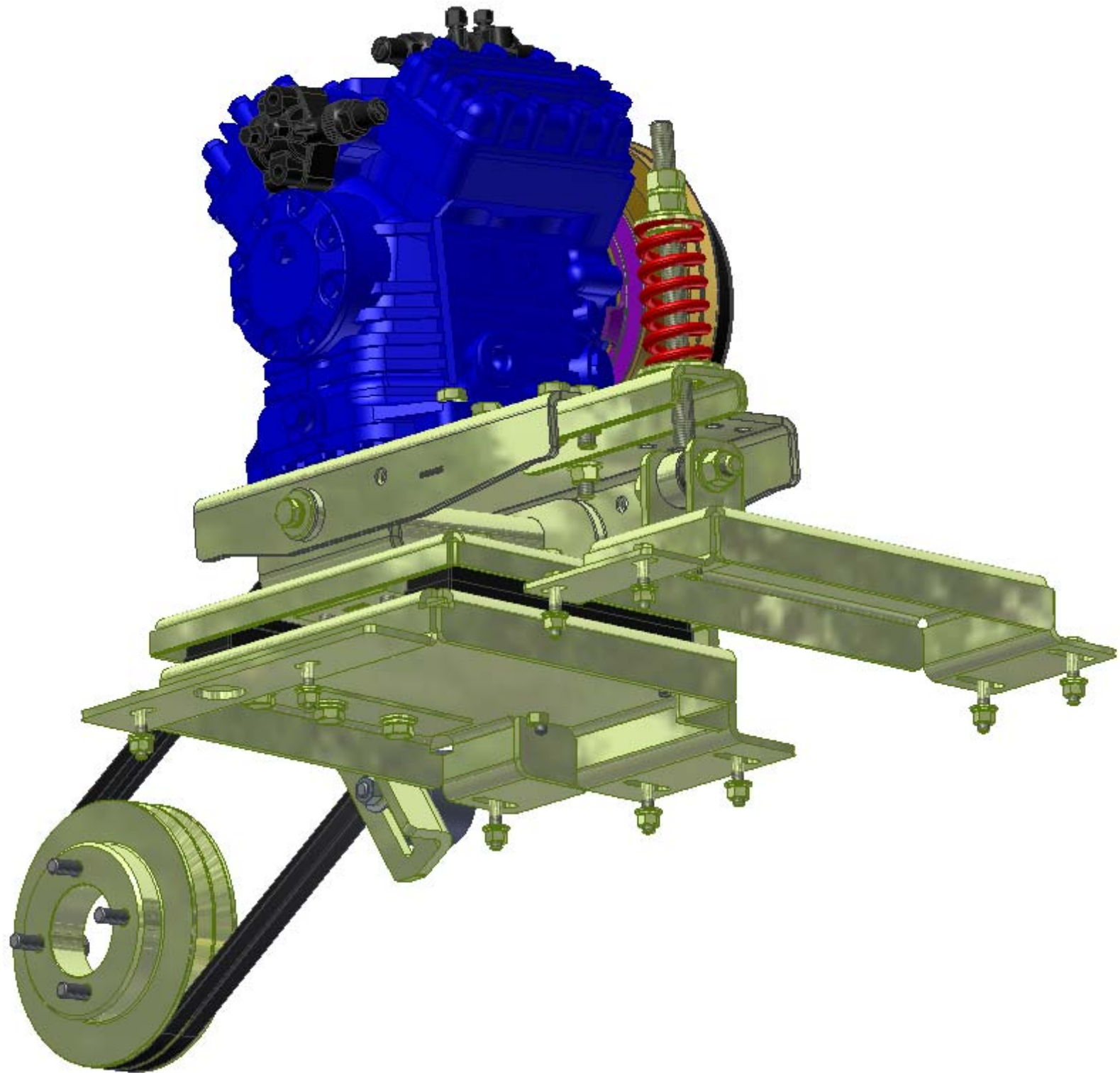

TransArctic A/C Compressor Mount Installation Disclaimer

All compressor mounts should be installed by qualified and trained personnel using proper tools and equipment in safe working conditions following industry standard guidelines for motor vehicle service and repair.

The installer of any compressor mount purchased from TransArctic must undertake all responsibility of issues arising from that compressor bracket being installed on any vehicle. As well as insure that a **proper and sufficient ground** is established between the compressors' clutches and the vehicle's engine. Mount functionality, operation and durability can all be compromised by an incompetent installation.

Due to the many different situations, parameters and application criteria, which are beyond the compressor mount manufacturer's control, TransArctic does not warrant design, durability, or operational functionality of any compressor mount improperly installed by another party.

With no implied guarantees it is the mount installer's strict responsibility to determine safety and functionality, of the compressor mount, at the time of installation.

Please contact TransArctic with any issue arising from installation so we may better improve the product. If you have any reservations about the compressor mount integrity contact TransArctic immediately at 1-877-COLD-AIR.

Mark OEM tensioner location

Install Kit

Check for Interferences

Check to ensure that the proper OEM tensioner orientation is maintained

Run engine with A/C system engaged for at least 10 minutes to run in belt

Check OEM tensioner orientation and adjust as required

Responsabilidad limitada de TransArctic en la instalación del soporte del compresor

Todos los soportes de los compresores deben ser instalados por personas calificadas y entrenadas, usando para ello los equipos y herramientas necesarios para esta labor en buenas condiciones y según las normas y guías para el servicio y/o reparación de motores de vehículos.

El instalador de los soportes comprados en TransArctic asume toda la responsabilidad de cualquier problema que surga en el soporte del compresor al vehículo; de igual manera es responsable que el cable a tierra sea conectado entre el embrague del compresor y el motor del vehículo.

Se advierte que el buen funcionamiento y la durabilidad del soporte pueden ser comprometidos por defectos en su instalación.

Debido a las diversas situaciones que se puedan presentar fuera del control del fabricante, TransArctic no garantiza el diseño, la durabilidad o el correcto funcionamiento de cualquier equipo inapropiadamente instalado por terceros.

Esta sobreentendido que el Instalador del montaje del compresor es estrictamente responsable de la seguridad y funcionamiento del equipo en el momento de la instalación.

Si tuviera algún problema o duda acerca de la instalación del soporte del compresor pongase en contacto inmediatamente con TransArctic al teléfono 1-877-COLD-AIR de modo que podamos mejorar nuestro producto.

Note la ubicación del medidor de tensión OEM

Instale el equipo

Controlar si hay interferencias.

Asegurese que el medidor de tensión mantenga la orientación justa.

Encienda el motor por lo menos 10 minutos con el sistema A/C enganchado para que la correa corra

Controle la orientación justa del medidor de tensión y ajuste a las condiciones requeridas del fabricante