

Bill of Materials Listing

TransArctic Canada Inc.

9/26/2022
Page 1 of 1

Product Number		Date		Description		Uof M	Weight	Yield	
Line	Qty	Component	Prod#	Rev#	Description	Location	Unit		
KSP41020			02/26/19	0	Mt Kit, Special, HDX, O5G, 24V,'22			144.27	0
5	1	PAC39131			Pack, Carton, 39" x 13" x 16.25", 51 BC		each		
10	1	BEL32389			Belt, Banded B gr,2388mm (94")		each		
20	1	BMC83125			1 Bkt, Weldm't, Adapter Pl, ISL, HDX, '13		each		
30	1	BMC90012			0 Bkt, Weldm't, Main Base, HDX, 16'		each		
35	1	BMD80003			0 Bkt, Hanger, Reservoir, DD8 RE		each		
50	1	KTT00005			0 Kit, 05G,TM65,Tensioner Bkt, Ass'y, '19		each		
60	1	KCB94195			1 Kit, Compressor, Alt, O5G, '16		each		
120	1	KBD84195			0 Bag Kit, Fasteners,KMD84195		each		

Bill of Materials Listing

TransArctic Canada Inc.

5/6/2019
Page 1 of 1

Product Number		Description	Rev#	Date	Weight	Uof M	Yield
Line	Component Prod#	Description	Bin	Unit	Qty		
KTT00005		Kit, 05G, Tensioner Bracket, Ass'y, '19	0	9/21/2017	27.95		0
5	BMD80001	Bkt, Idler, F/S-B/S Add-On, '19		each	1		
10	BMD80002	Bkt, Angle, HOR, HDX, DD8		each	1		
20	PUA05012	Pulley, Assy, Idler, B/BX gr, 5", STL, Plt		each	1		
25	PUA05001	Pulley, Assy, Idler, B/S, 5", Stl, Plt		each	1		
30	SCD21912	Spacer, Col, Drl, 21.9mm x 25.4o x 12.3i		each	2		
40	SLV17012	Sleeve, Pulley, 16.9o x 22.23mm x 12.32i		each	2		
50	KBT00005	Bag Kit, Fasteners, KTT00005		each	1		

Bill of Materials Listing

TransArctic Canada Inc.

4/29/2019
Page 1 of 1

Product Number		Description	Rev#	Date	Weight	Uof M	Yield
Line	Component Prod#	Description	Bin	Unit	Qty		
KBT00005		Bag Kit, Fasteners, KTT00005		9/21/2017	1.22		0
10	BTC12080	Bolt, Hex, 12 x 1.75 x 80mm, 10.9,Plt,FT		each	2		
15	BTC12040	Bolt, Hex, 12 x 1.75 x 40mm, 10.9,Plt,FT		each	2		
20	BTQ08126	Bolt, Hex, 1/2-20unf, 1.25", 8, Plt		each	3		
30	NTA12000	Nut, Hex, 12 x 1.75, 8.8, Plt		each	4		
35	WFA12000	Washer, Flat, 12mm, 8.8, Plt		each	2		
40	WFA12002	Washer, Flat, 12mm, Hvy, 8.8, Plt		each	2		
50	WFQ08000	Washer, Flat, 1/2", 8, Plt		each	3		
60	WLA12000	Washer, Lock, 12mm, 8.8, Plt		each	4		
70	WLQ08000	Washer, Lock, 1/2", 8, Plt		each	3		

Bill of Materials Listing

TransArctic Canada Inc.

4/25/2019
Page 1 of 1

Product Number		Description	Rev#	Date	Weight	Uof M	Yield
Line	Component Prod#	Description	Bin	Unit	Qty		
KCB94195		Kit, Compressor, Alt, O5G, '16	0	5/31/2016	60.37		0
10	BEL11138	Belt, A gr, 1138mm (44.8")		each	2		
20	BMC83114	Bkt, PI, ALT Spacer, T3RE, '13		each	1		
30	BMN80008	Vibration Isolator, Bar, 16.50 x 2 x 1.50		each	2		
40	BMN80025	Bkt, Back, PL, Slide, IC, RE300		each	1		
50	BMT10011	Bkt, Tenr, Block, Offset, 3mm		each	2		
60	BMZ00043	Bkt, Main, Base PI, '13		each	1		
70	KBT94195	Kit, Platform, O5G W/ Alt, '16		each	1		
80	PUL03321	Pulley, ALT, Idler, 3.25"d, 2A		each	1		
90	KBZ94195	Bag Kit, Fasteners, KCB92495 & KCB94195		each	1		

Bill of Materials Listing

TransArctic Canada Inc.

7/15/2016
Page 1 of 1

Product Number	Description	Date	Weight	Uof M	Yield
Line Component Prod#	Description	Bin Unit	Qty		
KBT94195	Kit, Platform, O5G W/ Alt, '16		5/31/2016	16.33	0
10	BMC90015	Bkt, Weldm't, Alt Extension, HDX, 16'	each	1	
20	BMN80010	Bkt, Main, Slide, Assy, O5G, IC, RE300	each	1	
30	BTQ06150	Bolt, Hex, 3/8-16unc, 1.50", 8, Plt	each	2	
40	NTP07000	Nut, Hex, 7/16-14unc, 5, Plt	each	4	
50	SCD29213	Spacer, Col, Drl, 29.21mm x 25.4o x 12.7i	each	1	
60	WFN06000	Washer, Flat, 3/8", 2, Plt	each	2	
70	WFN07000	Washer, Flat, 7/16", 2, Plt	each	4	
80	WLQ06000	Washer, Lock, 3/8", 8, Plt	each	2	
90	WLQ07000	Washer, Lock, 7/16", 8, Plt	each	4	

Bill of Materials Listing

TransArctic Canada Inc.

4/25/2019
Page 1 of 1

Product Number		Description	Rev#	Date	Weight	Uof M	Yield
Line	Component Prod#	Description	Bin	Unit	Qty		
KBZ94195		Bag Kit, Fasteners, KCB92495 & KCB94195		6/13/2016	2.45		0
10	BTP08653	Bolt, Hex, 1/2-13unc, 6.5", 5, Plt, FT		each	1		
20	BTQ08101	Bolt, Hex, 1/2-20unf, 1.00", 8, Plt		each	4		
30	BTQ08150	Bolt, Hex, 1/2-13unc, 1.5", 8, Plt		each	3		
40	BTQ08200	Bolt, Hex, 1/2-13unc, 2.0", 8, Plt		each	1		
50	BTQ08653	Bolt, Hex, 1/2-13unc, 6.5", 8, Plt		each	1		
60	CSF08076	Capscrew, FH, 1/2-20unf x .75",Alloy,Plt		each	2		
70	NTQ08000	Nut, Hex, 1/2-13unc, 8, Plt		each	7		
80	TRD08120	Threaded, Rod, 1/2-13unc x 12", 5, Plt		each	1		
90	WFQ08000	Washer, Flat, 1/2", 8, Plt		each	10		
100	WLQ08000	Washer, Lock, 1/2", 8, Plt		each	12		

Bill of Materials Listing

TransArctic Canada Inc.

5/2/2019
Page 1 of 1

Product Number		Description	Rev#	Date	Weight	Uof M	Yield
Line	Component Prod#	Description	Bin	Unit	Qty		
KBD84195		Bag Kit, Fasteners,KMD84195	0	6/1/2016	1.59		0
30	BTQ06175	Bolt, Hex, 3/8-16unc, 1.75", 8, Plt		each	5		
35	BTQ06100	Bolt, Hex, 3/8-16unc, 1", 8, Plt		each	2		
40	BTQ08125	Bolt, Hex, 1/2-13unc, 1.25", 8, Plt		each	2		
50	BTQ08151	Bolt, Hex, 1/2-20unf, 1.5", 8, Plt		each	2		
55	CSF08101	Capscrew, FH, 1/2-20unf x 1.0",Alloy,Plt		each	4		
80	NTQ06000	Nut, Hex, 3/8-16unc, 8, Plt		each	7		
110	WFQ08000	Washer, Flat, 1/2", 8, Plt		each	4		
115	WFP06000	Washer, Flat, 3/8", 5, Plt		each	2		
120	WFS06002	Washer, Flat, 3/8", L9, Plt		each	10		
150	WLQ06000	Washer, Lock, 3/8", 8, Plt		each	7		
160	WLQ08000	Washer, Lock, 1/2", 8, Plt		each	4		

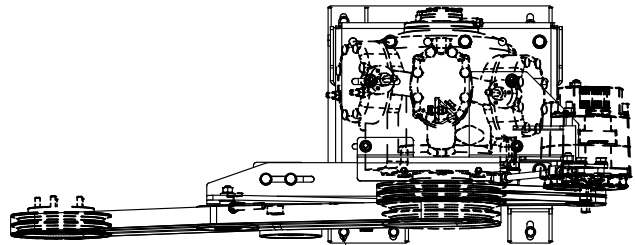

x5 8 12 15 16

4

NOTE:
CARRIER COMPRESSOR
PART#: 68PD541-124-xx

x2 18

11

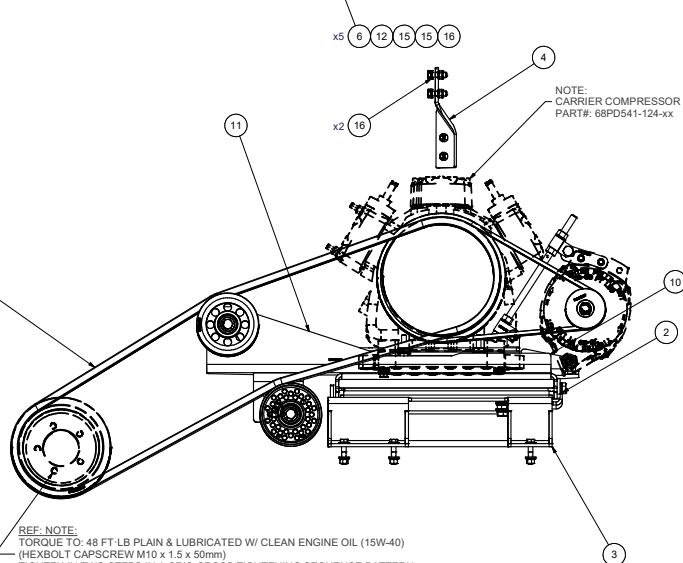

1

10

2

3

REF. NOTE:
TORQUE TO: 48 FT-LB PLAIN & LUBRICATED W/ CLEAN ENGINE OIL (15W-40)
(HEXBOLT CAPSCREW M10 x 1.5 x 50mm)
TIGHTEN IN TWO STEPS IN A CRIS-CROSS TIGHTENING SEQUENCE PATTERN.

x4 9

x2 8 14 17

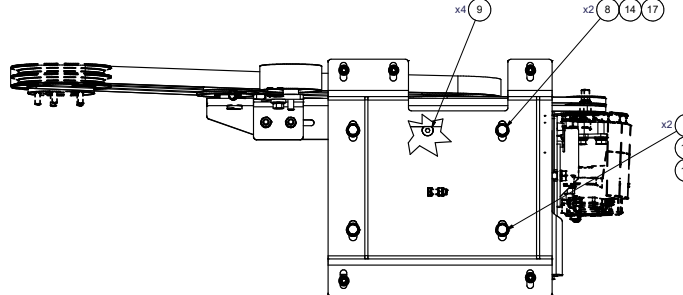

x2 7

14

17

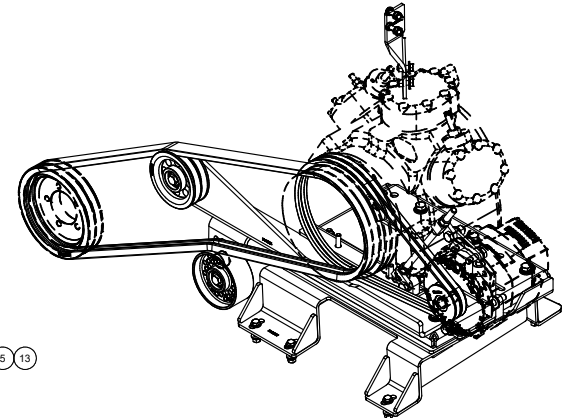

ISOMETRIC VIEW

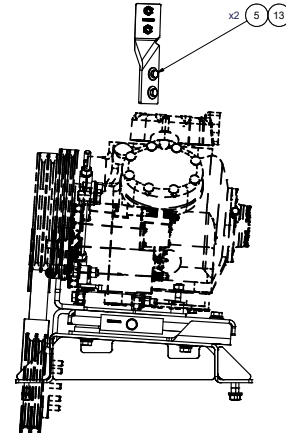

x2 5 13

NOTES:
1) USE SERVICABLE THREADLOCKER ON ALL FASTENERS TO ENGINE COMPONENTS AND TORQUE ALL BOLTS TO S.A.E. SPECIFICATIONS.
2) SEE *TRANSARCTIC A/C COMPRESSOR MOUNT INSTALLATION DISCLAIMER*.

ITEM	QTY	U/M	PART NUMBER	DESCRIPTION
17	4	EACH	WLQ08000	WASHER, LOCK, 1/2", 8, PLT
16	7	EACH	WLQ06000	WASHER, LOCK, 3/8", 8, PLT
15	10	EACH	WFS06002	WASHER, FLAT, 3/8", L9, PLT
14	4	EACH	WFO08000	WASHER, FLAT, 1/2", 8, PLT
13	2	EACH	WFP06000	WASHER, FLAT, 3/8", 5, PLT
12	7	EACH	NTQ06000	NUT, HEX, 3/8-16UNC, 8, PLT
11	1	EACH	KTT00005	KIT, 05G, TENSIONER BRACKET ASSY, '19
10	1	EACH	KCB94195	KIT, COMPRESSOR, ALT, 05G, '16
9	4	EACH	CSF08076	CAPSCREW, FH, 1/2-20UNF x .75", ALLOY, PLT
8	2	EACH	BTQ08151	BOLT, HEX, 1/2-20UNF x 1.50, 8, PLT
7	2	EACH	BTQ08125	BOLT, HEX, 1/2-13UNC x 1.25, 8, PLT
6	5	EACH	BTQ06175	BOLT, HEX, 3/8-16UNC, 1.75", 8, PLT
5	2	EACH	BTQ06100	BOLT, HEX, 3/8-16UNC, 1", 8, PLT
4	1	EACH	BMD80003	BKT, HANGER, RESEVOIR, DD8 RE
3	1	EACH	BMC90012	BKT, WELDMT, MAIN BASE, HDX, '16
2	1	EACH	BMC83125	BKT, WELDMT, ADAPTER PL, ISL, HDX, '13
1	1	EACH	BEL32388	BELT, BANDED B GR, 2388mm (94)

TRANSARCTIC INC.

MT KIT, SPECIAL, HDX, 05G, 24V, '22

DATE: 09/27/22 BY: Dale Mason

SCALE: 1:5

SHEET 1 OF 1

REV	ECN	DESCRIPTION	DATE	BY
0		RELEASED TO PRODUCTION	09/27/2022	VAL
		CHECKED	09/27/22	Jose Rodriguez
		APPROVED	09/27/22	James Stewart
		APPROVED	09/27/22	Dale Mason

UNSPECIFIED TOLERANCES:

ONE DECIMAL PLACE (.XX)	MM	THIRD ANGLE PROJECTION
TWO DECIMAL PLACE (.XXX)	MM	
THREE DECIMAL PLACE (.XXXX)	MM	
FRACTIONAL (1/16")	INCH	

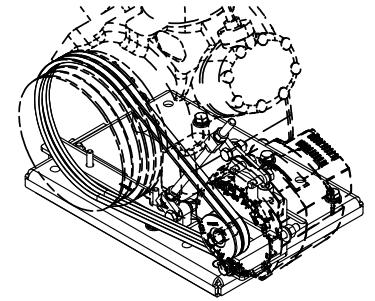
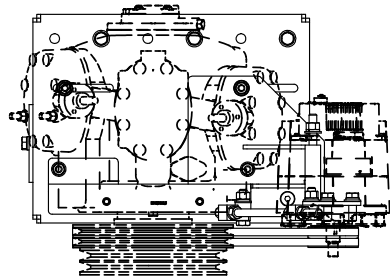
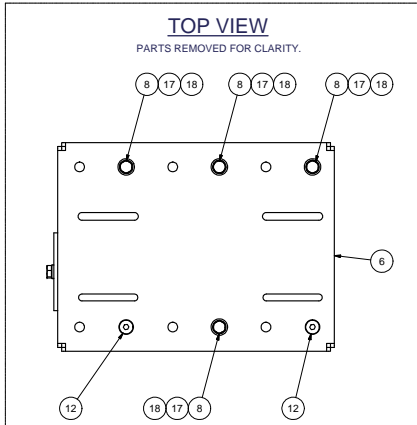

ISOMETRIC VIEW

NOTE:
CARRIER COMPRESSOR
PART#: 68PD541-124-xx

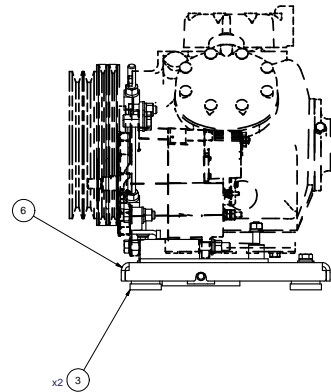
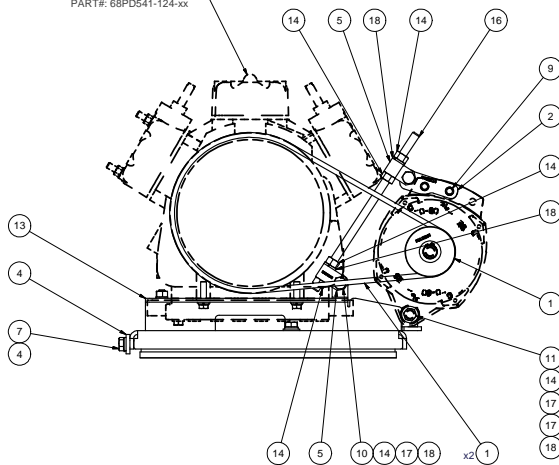

NOTES:

- 1) USE SERVICABLE THREADLOCKER ON ALL FASTENERS TO ENGINE COMPONENTS AND TORQUE **ALL** BOLTS TO S.A.E. SPECIFICATIONS.
- 2) SEE "TRANSARCTIC A/C COMPRESSOR MOUNT INSTALLATION DISCLAIMER".
- 3) WEIGHT: 56.87LBS.

ITEM	QTY	U/M	PART NUMBER	DESCRIPTION
18	12	EACH	WLO08000	WASHER, LOCK, 1/2", 8, PLT
17	10	EACH	WFO08000	WASHER, FLAT, 1/2", 8, PLT
16	1	EACH	TRD08120	THREADED, ROD, 1/2-13UNC x 12", 5 PLT
15	1	EACH	PUL03321	PULLEY, ALT, IDLER, 3.25"o, 2A
14	7	EACH	NT008000	NUT, HEX, 1/2-13UNC, 8, PLT
13	1	EACH	K8194195	KIT, PLATFORM, O5G W/ ALT, '16
12	2	EACH	CSF08076	CAPSCREW, FH, 1/2-20UNF x .75", ALLOY, PLT
11	1	EACH	BTQ08653	BOLT, HEX, 1/2-13UNC x 6.50, 8, PLT
10	1	EACH	BTQ08200	BOLT, HEX, 1/2-13UNC x 2.00, 8, PLT
9	3	EACH	BTQ08150	BOLT, HEX, 1/2-13UNC x 1.50, 8, PLT
8	4	EACH	BTQ08101	BOLT, HEX, 1/2-20UNF x 1.00, 8, PLT
7	1	EACH	BTQ08653	BOLT, HEX, 1/2-13UNC x 6.50, 5, PLT, FT
6	1	EACH	BMZ00043	BKT, MAIN, BASE PL, '13
5	2	EACH	BMT10011	BKT, TENR, BLOCK, OFFSET, 3mm
4	1	EACH	BMN80025	BKT, BACK, PL, SLIDE, IC, RE300
3	2	EACH	BMN80008	VIBRATION ISOLATOR, BAR, 16.50 x 2 x 1.50
2	1	EACH	BMCS3114	BKT, PL, ALT, SPACER, T3RE, '13
1	2	EACH	BELT1138	BELT, A GR, 1138mm (44.8") (17448)

TRANSARCTIC INC.

BROWN	5/30/2016	J Rodriguez	
CHECKED	5/30/2016	Jose Rodriguez	
REV	DESCRIPTION	DATE	BY
0	RELEASED TO PRODUCTION	5/30/2016	JRR
1	APPROVED	5/30/2016	James Stewart
2	APPROVED	5/30/2016	James Stewart
3	APPROVED	5/30/2016	Dale Mason

BILL OF MATERIALS	
TITLE	KIT, COMPRESSOR, 24V, O5G, '16
SIZE	D
DWG NO	KCB94195
SCALE	1:4
SHEET	1 OF 1

UNSPECIFIED TOLERANCES: ALL DIMS
 DIM DECIMAL PLACE (X) .00 (FRACTIONAL) 1/32
 DIM FRACTIONAL PLACE (X) 1/32 (FRACTIONAL) 1/32
 DIM FRACTIONAL PLACE (X) 1/32 (FRACTIONAL) 1/32
 DIM FRACTIONAL PLACE (X) 1/32 (FRACTIONAL) 1/32



DRAWING UNIT OF MEASURE: MM (INCH)

REV 0

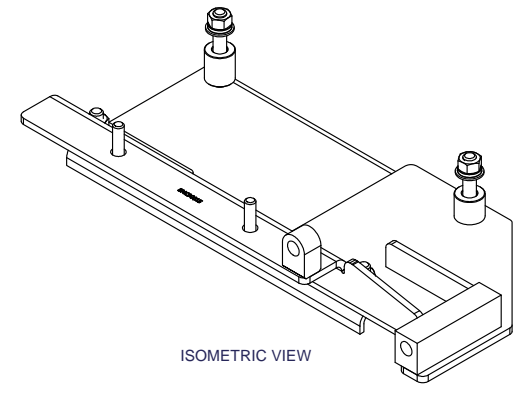
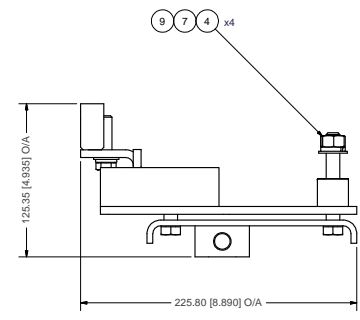
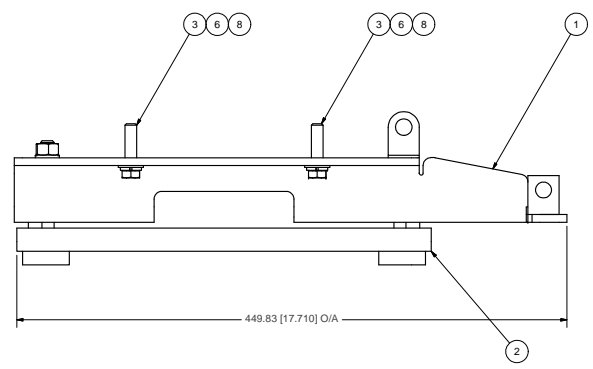
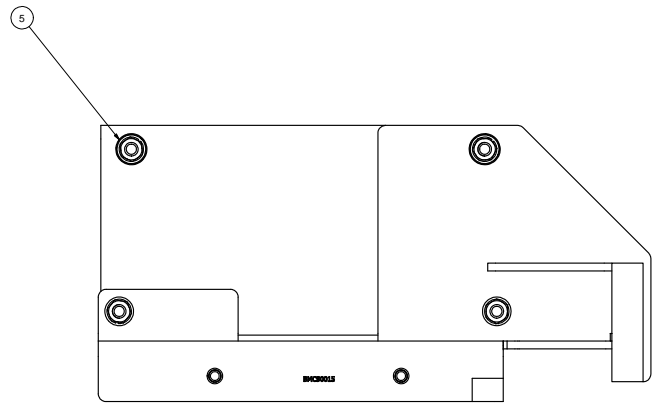

ISOMETRIC VIEW

- NOTES:**
- 1) USE SERVICABLE THREADLOCKER ON ALL FASTENERS TO ENGINE COMPONENTS AND TORQUE **ALL** BOLTS TO S.A.E. SPECIFICATIONS.
 - 2) SEE "TRANSARCTIC A/C COMPRESSOR MOUNT INSTALLATION DISCLAIMER".
 - 3) WEIGHT: 16.25 LBS.

ITEM	QTY	U/M	PART NUMBER	DESCRIPTION
9	4	EACH	WLO07000	WASHER, LOCK, 7/16", 8, PLT
8	2	EACH	WLO06000	WASHER, LOCK, 3/8", 8, PLT
7	4	EACH	WFO70000	WASHER, FLAT, 7/16", 2, PLT
6	2	EACH	WFO06000	WASHER, FLAT, 3/8", 2, PLT
5	1	EACH	SCD29213	SPACER, COL, DRL, 29.21mm x 25.4o x 12.7i
4	4	EACH	NTP07000	NUT, HEX, 7/16-14UNC, 5, PLT
3	2	EACH	BTO06150	BOLT, HEX, 3/8-16UNC, 1.50", 8, PLT
2	1	EACH	BMN00010	BKT, MAIN, SLIDE, ASSY, IC, RE300
1	1	EACH	BMC90015	BKT, WELDMT, ALT EXTENSION, HDX, '16

BILL OF MATERIALS

TRANSARCTIC INC.

DRAWN jrodriguez	5/31/2016	TITLE	
CHECKED Jose Rodriguez	5/31/2016	DATE	
REVISION A	RELEASED TO PROTOTYPE	5/31/2016	JRR
REVISION B	DESCRIPTION:	DATE:	BY:
APPROVED James Stewart	5/31/2016		
APPROVED Dale Mason	5/31/2016		

THIS DRAWING CONTAINS PROPRIETARY CONFIDENTIAL INFORMATION OWNED BY TRANSARCTIC CANADA INC. THE DOCUMENT AND THE INFORMATION IN IT ARE NOT TO BE USED, DISCLOSED OR REPRODUCED WITHOUT EXPRESS WRITTEN PERMISSION OF THE COMPANY.

UNSPECIFIED TOLERANCES:	PLT DIM	FINISH	THIRD ANGLE PROJECTION
ONE DECIMAL PLACE (X.0)	30	SPR	
TWO DECIMAL PLACE (X.00)	30	SPR	
THREE DECIMAL PLACE (X.000)	30	SPR	
FRACTIONAL (1/32")	30	SPR	

DRAWING UNIT OF MEASURE	MM [INCH]	SCALE	1:2	DWG NO	KBT94195	REV	0
SHEET		1	OF	1			

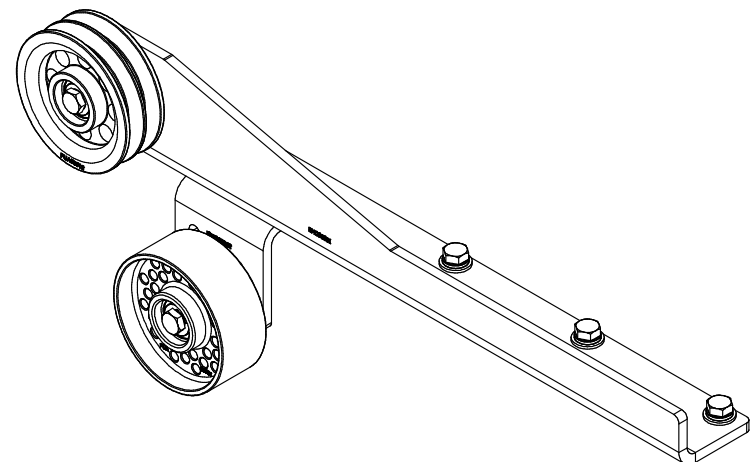
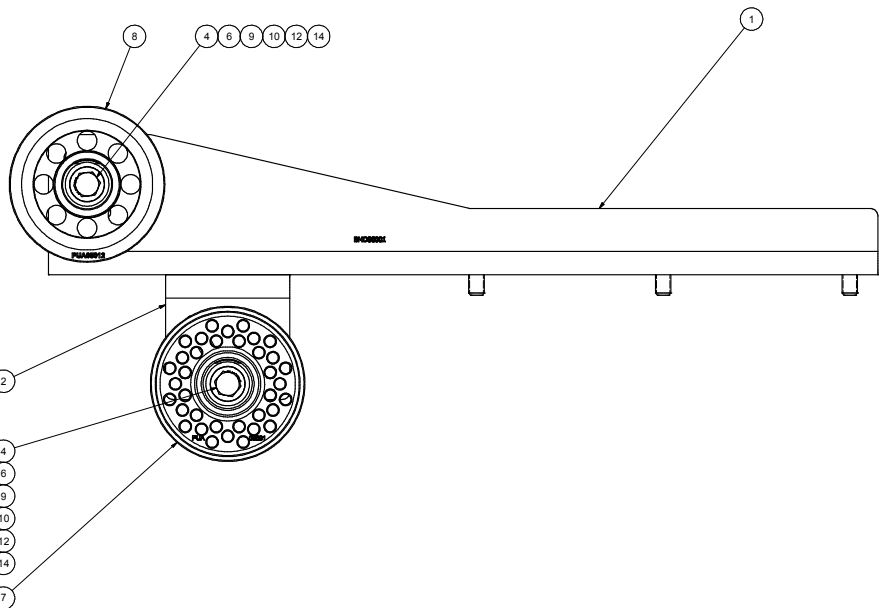
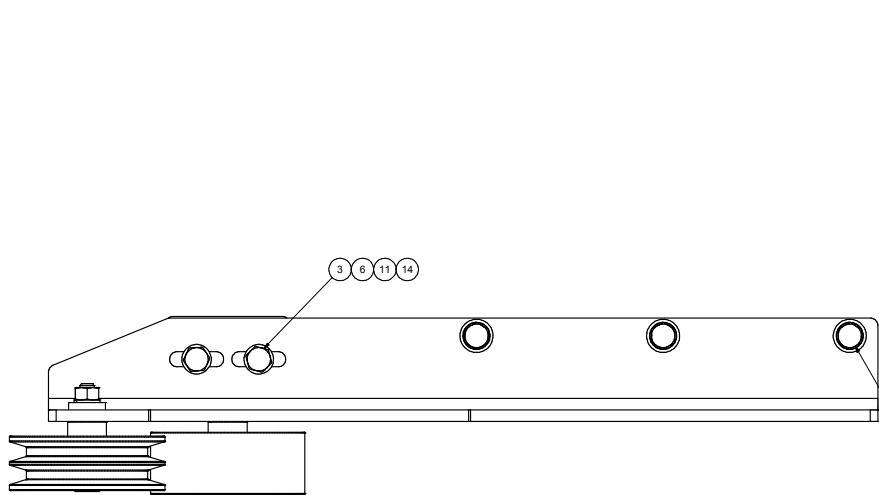

ISOMETRIC VIEW

NOTES:

- 1) USE SERVICABLE THREADLOCKER ON ALL FASTENERS TO ENGINE COMPONENTS AND TORQUE **ALL** BOLTS TO S.A.E. SPECIFICATIONS.
- 2) SEE "TRANSARCTIC A/C COMPRESSOR MOUNT INSTALLATION DISCLAIMER".

15	3	EACH	WL08000	WASHER, LOCK, 1/2", 8, PLT
14	4	EACH	WLA12000	WASHER, LOCK, 12mm, 8.8, PLT
13	3	EACH	WFP06000	WASHER, FLAT, 3/8", 8, PLT
12	2	EACH	WFA12002	WASHER, FLAT, 12mm, HVY, 8.8, PLT
11	2	EACH	WFA12000	WASHER, FLAT, 12mm, 8.8, PLT
10	2	EACH	SLV17012	SLEEVE, PULLEY, 16.90 x 22.23 mm x12.19"
9	2	EACH	SCD21912	SPACER, COL., DRL, 21.9mm x 31.80 x12.31
8	1	EACH	PLA05012	PULLEY, ASSY, IDLER, 8/8X gr, 5" STL, PLT
7	1	EACH	PLA05001	PULLEY, ASSY, IDLER, 8/8, 5", STL, PLT
6	4	EACH	NTA12000	NUT, HEX, 12 x 1.75, 8.8, PLT
5	3	EACH	BTQ08126	BOLT, HEX, 1/2-20UNF x 1.25, 8, PLT
4	2	EACH	BTC12080	BOLT, HEX, 12 x 1.75 x 80mm, 10.9, PLT
3	2	EACH	BTC12040	BOLT, HEX, 12 x 1.75 x 40mm, 10.9, PLT
2	1	EACH	BMD80002	BKT, ANGLE, HOR, HDX, DD8
1	1	EACH	BMD80001	BKT, IDLER, F/S-B/S ADD-ON, '19

ITEM	QTY	U/M	PART NUMBER	DESCRIPTION
BILL OF MATERIALS				
DRAWN		vjakowlew		4/11/2019
CHECKED		Jose Rodriguez		4/29/2019
BY		James Stewart		4/29/2019
APPROVED		Dale Mason		4/29/2019
REV		ECN		DESCRIPTION
0		RELEASED TO PRODUCTION	5/7/2019	VAL
THIS DRAWING CONTAINS PROPRIETARY CONFIDENTIAL INFORMATION OWNED BY TRANSARCTIC CANADA INC. THE DOCUMENT AND THE INFORMATION IN IT ARE NOT TO BE USED, DISCLOSED OR REPRODUCED WITHOUT EXPRESS WRITTEN PERMISSION OF THE COMPANY.				
UNSPECIFIED TOLERANCES:		ALL DIMS	FINISH	
ONE DECIMAL PLACE (X1)	±0.1	20	1.000	
TWO DECIMAL PLACE (X2)	±0.05	20	1.000	
THREE DECIMAL PLACE (X3)	±0.025	20	1.000	
FRACTIONAL (X1/8)	±0.0156	20	1.000	
DRAWING UNIT OF MEASURE:		MM (INCH)	SCALE	1:2
DWG NO		KTT00005		REV 0



REV	ECN	DESCRIPTION	DATE	BY
0		RELEASED TO PRODUCTION	5/7/2019	VAL
THIS DRAWING CONTAINS PROPRIETARY CONFIDENTIAL INFORMATION OWNED BY TRANSARCTIC CANADA INC. THE DOCUMENT AND THE INFORMATION IN IT ARE NOT TO BE USED, DISCLOSED OR REPRODUCED WITHOUT EXPRESS WRITTEN PERMISSION OF THE COMPANY.				
UNSPECIFIED TOLERANCES:		ALL DIMS	FINISH	
ONE DECIMAL PLACE (X1)	±0.1	20	1.000	
TWO DECIMAL PLACE (X2)	±0.05	20	1.000	
THREE DECIMAL PLACE (X3)	±0.025	20	1.000	
FRACTIONAL (X1/8)	±0.0156	20	1.000	
DRAWING UNIT OF MEASURE:		MM (INCH)	SCALE	1:2
DWG NO		KTT00005		REV 0



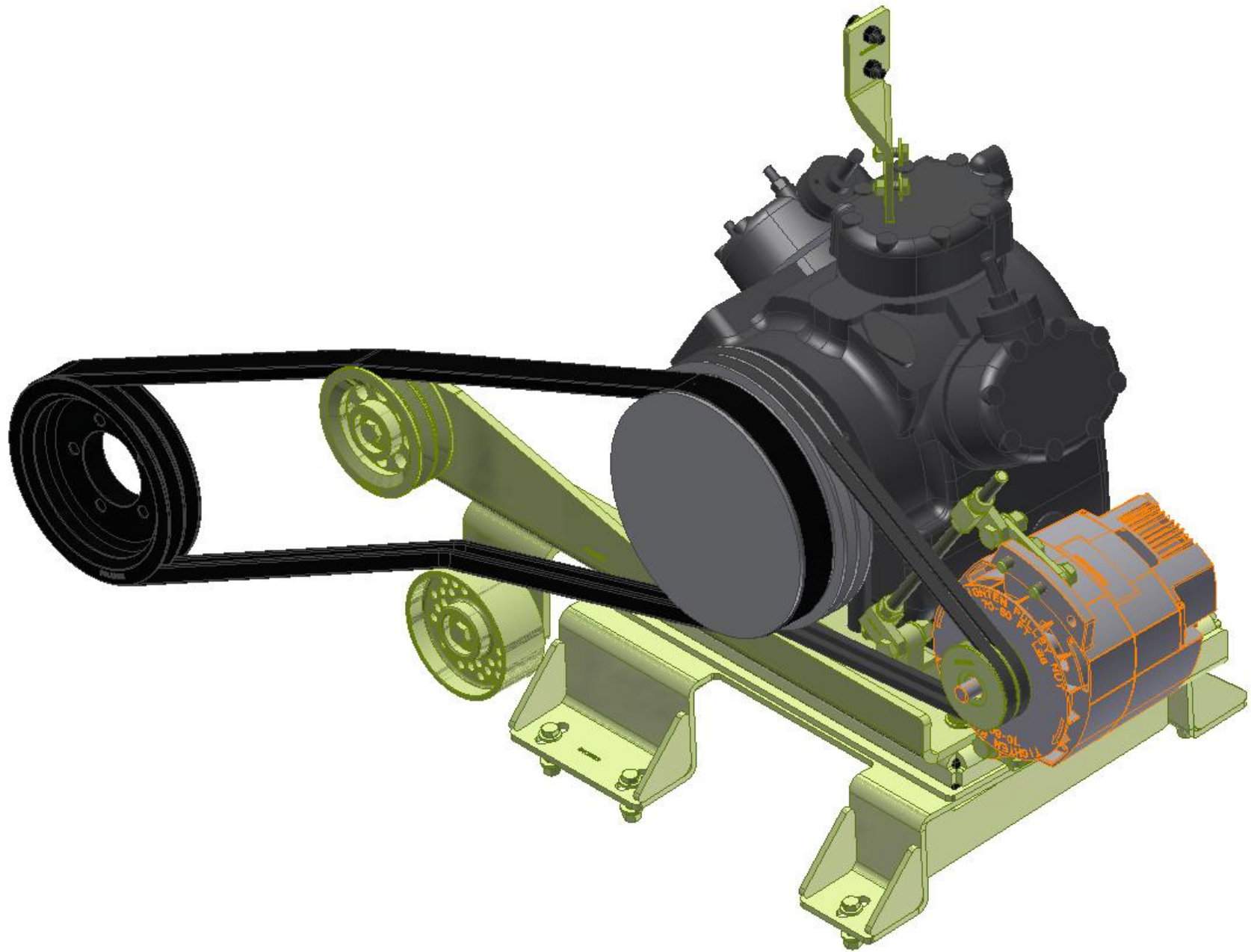

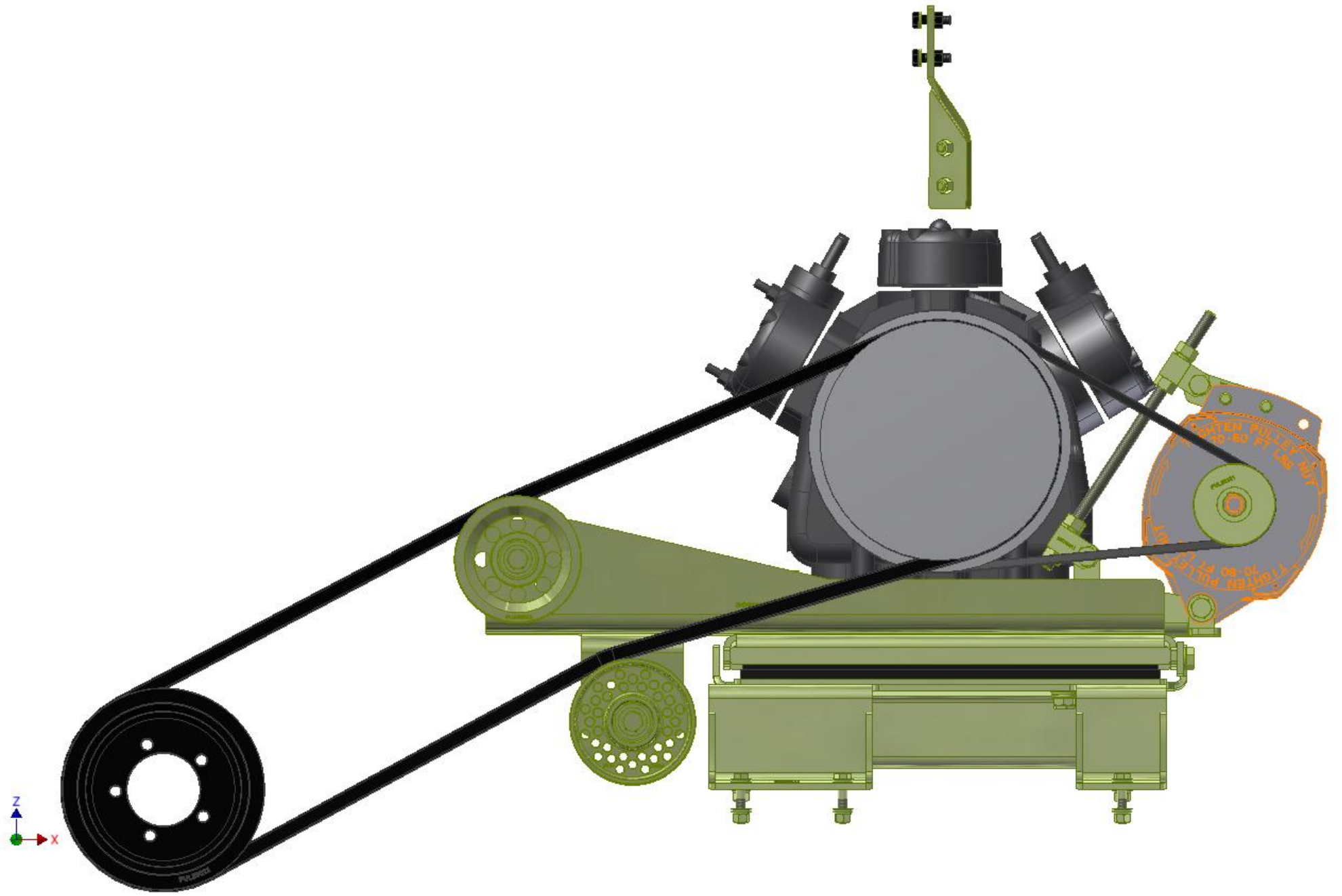

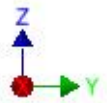
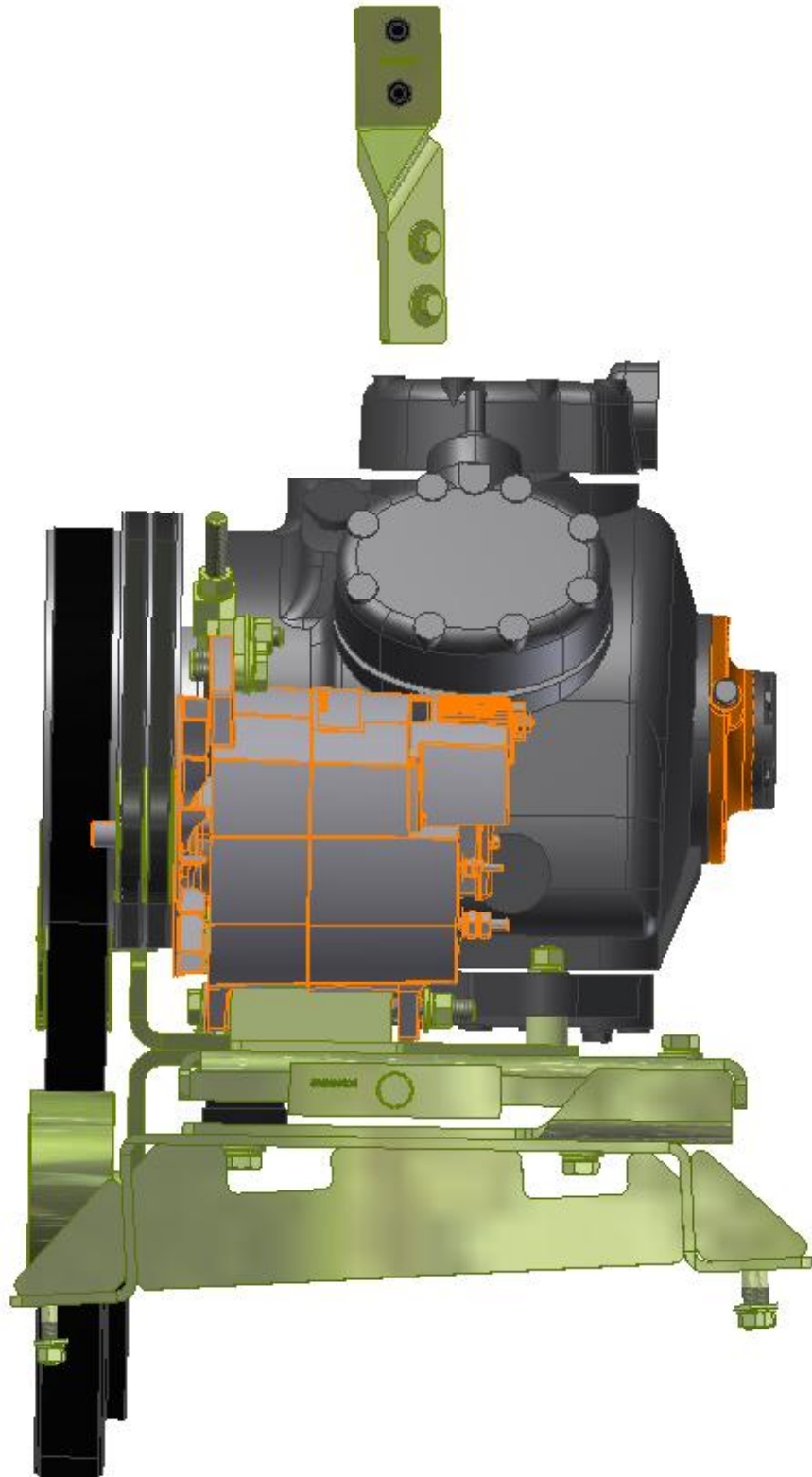

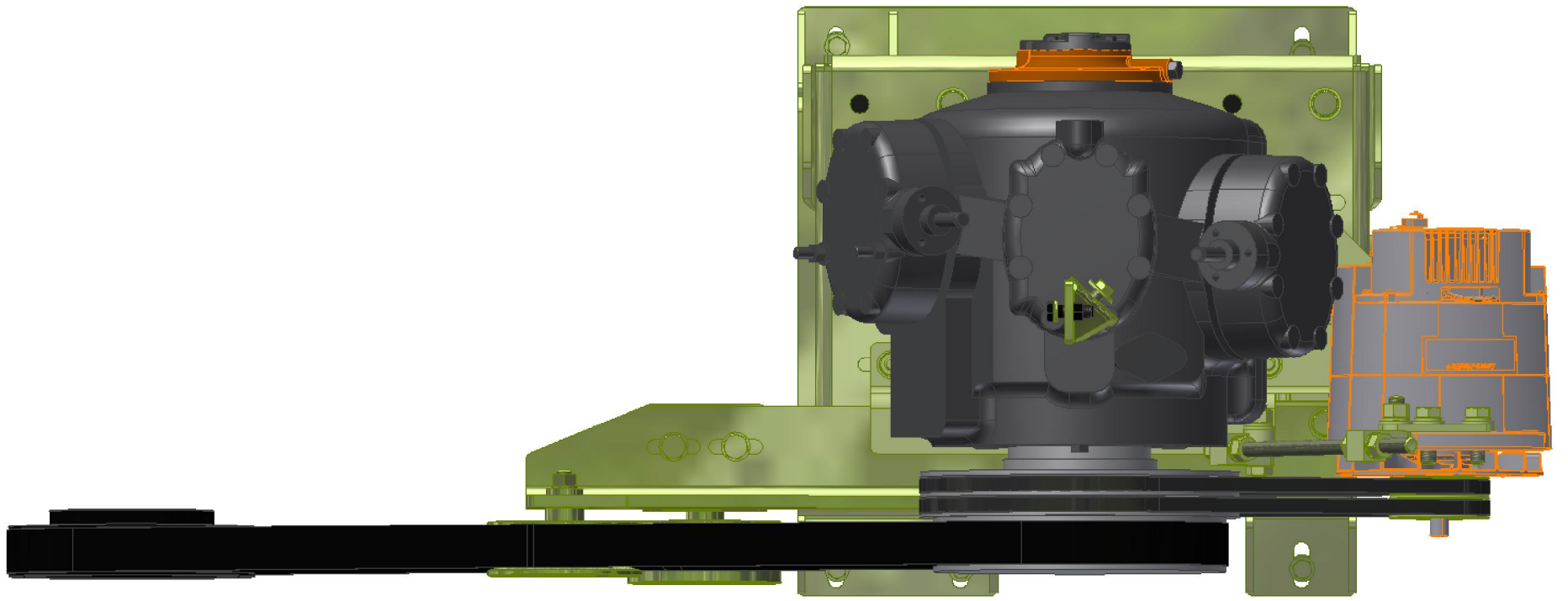

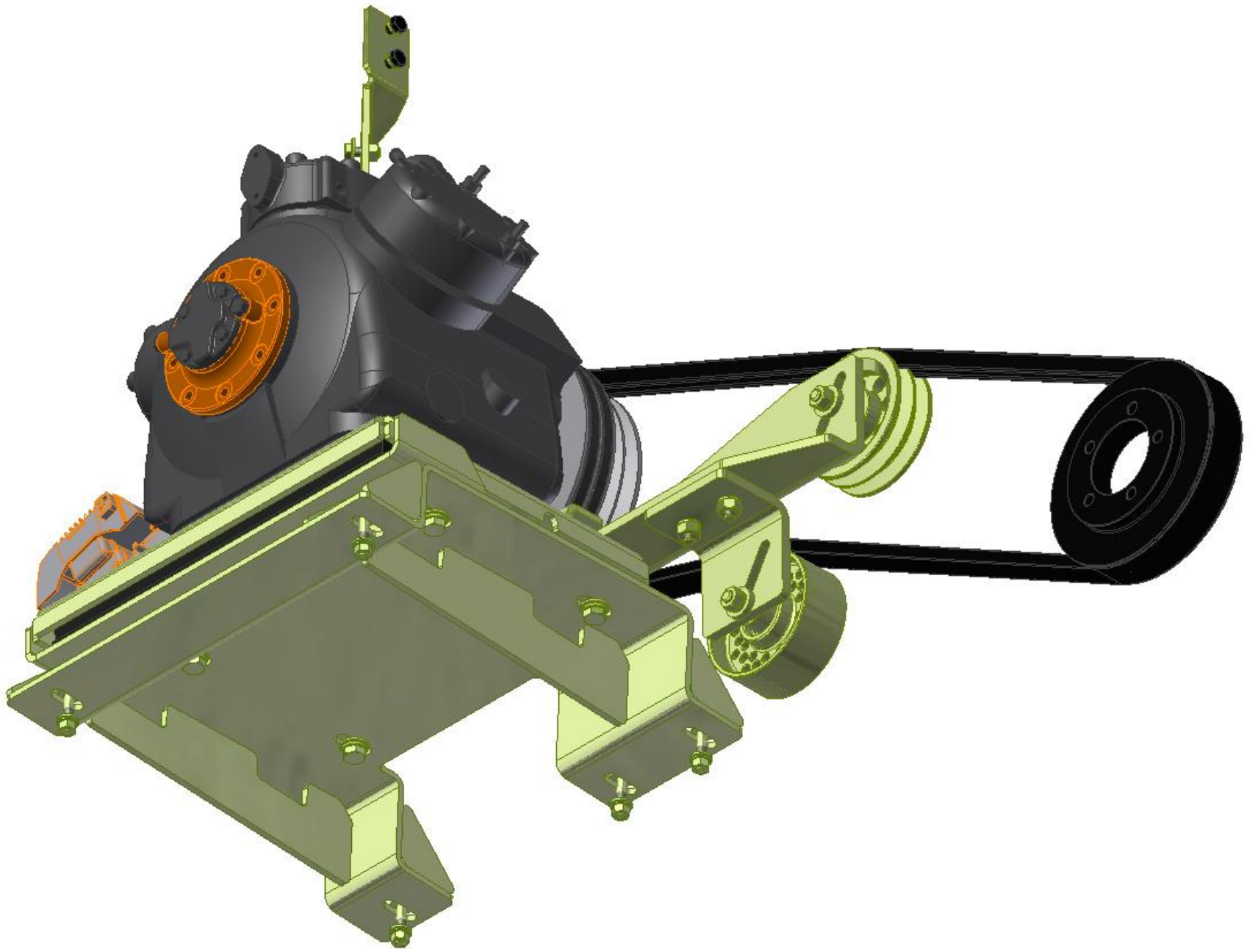

TransArctic A/C Compressor Mount Installation Disclaimer

All compressor mounts should be installed by qualified and trained personnel using proper tools and equipment in safe working conditions following industry standard guidelines for motor vehicle service and repair.

The installer of any compressor mount purchased from TransArctic must undertake all responsibility of issues arising from that compressor bracket being installed on any vehicle. As well as insure that a **proper and sufficient ground** is established between the compressors' clutches and the vehicle's engine. Mount functionality, operation and durability can all be compromised by an incompetent installation.

Due to the many different situations, parameters and application criteria, which are beyond the compressor mount manufacturer's control, TransArctic does not warrant design, durability, or operational functionality of any compressor mount improperly installed by another party.

With no implied guarantees it is the mount installer's strict responsibility to determine safety and functionality, of the compressor mount, at the time of installation.

Please contact TransArctic with any issue arising from installation so we may better improve the product. If you have any reservations about the compressor mount integrity contact TransArctic immediately at 1-877-COLD-AIR.

Mark OEM tensioner location

Install Kit

Check for Interferences

Check to ensure that the proper OEM tensioner orientation is maintained

Run engine with A/C system engaged for at least 10 minutes to run in belt

Check OEM tensioner orientation and adjust as required

Responsabilidad limitada de TransArctic en la instalación del soporte del compresor

Todos los soportes de los compresores deben ser instalados por personas calificadas y entrenadas, usando para ello los equipos y herramientas necesarios para esta labor en buenas condiciones y según las normas y guías para el servicio y/o reparación de motores de vehículos.

El instalador de los soportes comprados en TransArctic asume toda la responsabilidad de cualquier problema que surga en el soporte del compresor al vehículo; de igual manera es responsable que el cable a tierra sea conectado entre el embrague del compresor y el motor del vehículo.

Se advierte que el buen funcionamiento y la durabilidad del soporte pueden ser comprometidos por defectos en su instalación.

Debido a las diversas situaciones que se puedan presentar fuera del control del fabricante, TransArctic no garantiza el diseño, la durabilidad o el correcto funcionamiento de cualquier equipo inapropiadamente instalado por terceros.

Esta sobreentendido que el Instalador del montaje del compresor es estrictamente responsable de la seguridad y funcionamiento del equipo en el momento de la instalación.

Si tuviera algún problema o duda acerca de la instalación del soporte del compresor pongase en contacto inmediatamente con TransArctic al teléfono 1-877-COLD-AIR de modo que podamos mejorar nuestro producto.

Note la ubicación del medidor de tensión OEM

Instale el equipo

Controlar si hay interferencias.

Asegurese que el medidor de tensión mantenga la orientación justa.

Encienda el motor por lo menos 10 minutos con el sistema A/C enganchado para que la correa corra

Controle la orientación justa del medidor de tensión y ajuste a las condiciones requeridas del fabricante