

Bill of Materials Listing

TransArctic Canada Inc.

8/26/2014
Page 1 of 1

Product Number	Description	Date	Weight	Uof M	Yield
Line Component Prod#	Description	Bin Unit	Qty		
KMK72502	Mt Kit, C7, Vision, F400, 07	08/11/08	30.80		0
10 BMK70091	Bkt, Main, Weldmt, CAT C7, F400, 07	each	1		
20 BMK70103	BKT, RR, BRACE, Weldmt, CAT C7, F400, 07	each	1		
30 PUL81074	Pulley, Idler, Frontside, P8,74d (89103)	each	1		
40 TEN80002	Tenr, HD Spring, BackSide, CCW (89200A)	each	1		
50 SCD11617	Spacer, Col, Drl, 11.6mm x 28.6o x 17i	each	1		
60 NTS10460	Nut, Tensioner, 10 mm, 46.0 mm o/a, PLT	each	1		
70 BEL81664	Belt, 8gr, 1664mm (65.5") (5080655)	each	1		
90 HOA04045	Hose, Flex, CAC,Elb,Silicon,4.0 x 45d,FC	each	1		
100 HOA03545	Hose, Flex, CAC,Elb,Silicon,3.5 x 45d,FC	each	1		
200 KBK72502	Bag Kit, Fasteners, KMK72502	each	1		
210 BTS05100	Bolt, Stud,EXT, 5/16-18unc, 1", Plt	each	1		
220 CLP16001	Clamp, Gear, #16, 15/16-1 1/2, S	each	2		
230 HOA01125	Hose, Elbow, 1" ID, 12.5" O/A, 90 Deg	each	1		
240 FTS16001	Ftg, Hose, Splice, 1" d, STL, PLT	each	1		
250 TUS04035	Tube,Stl,3.5"/4"O.D,8x5.75x5.25,2x45 Deg	each	1		

NOTE:

- 1) Belt runs in the "REAR 8 grooves" of the compressor pulley.

Bill of Materials Listing

TransArctic Canada Inc.

8/26/2014
Page 1 of 1

Product Number	Description	Date	Weight	Uof M	Yield
Line Component Prod#	Description	Bin Unit	Qty		
KBK72502	Bag Kit, Fasteners, KMK72502		09/05/08	1.10	0
10	BTS10001		Bolt, Shoulder, 10mm (89064)	each	1
30	CSF10031		Capscrew, FH, 10 x 1.5 x 30mm, 10.9,Plt	each	1
40	BTC10080		Bolt, Hex, 10 x 1.5 x 80mm, 10.9, Plt,FT	each	1
50	WLA10000		Washer, Lock, 10mm, 8.8, Plt	each	9
60	WFA10000		Washer, Flat, 10mm, 8.8, Plt	each	9
70	BTC10075		Bolt, Hex, 10 x 1.5 x 75mm, 10.9, Plt	each	2
80	BTC10035		Bolt, Hex, 10 x 1.5 x 35mm, 10.9, Plt,FT	each	6
100	NTA10000		Nut, Hex, 10 x 1.5, 8.8, Plt	each	1
110	NTA08000		Nut, Hex, 8 x 1.25, 8.8, Plt	each	3
120	BTC08101		Bolt, Hex, 8 x 1.25 x 100mm, 10.9,Plt,FT	each	1
140	WFA08000		Washer, Flat, 8mm, 8.8, Plt	each	3
150	WLA08000		Washer, Lock, 8mm, 8.8, Plt	each	1

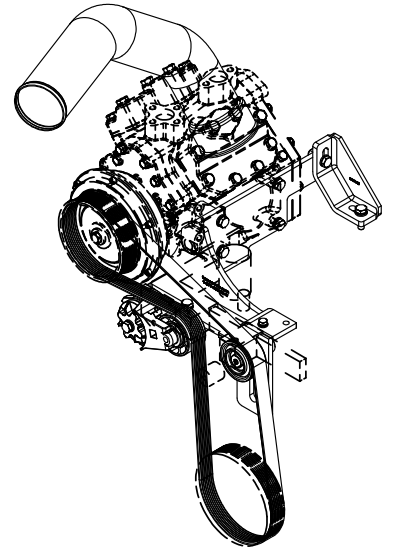
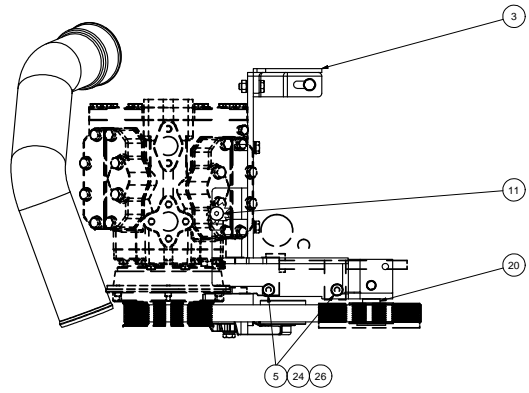

ISOMETRIC VIEW

NOTE:
INSTALL THE 8 GR. BELT ON THE
BACK 8 GROOVES OF THE
COMPRESSOR PULLEY.

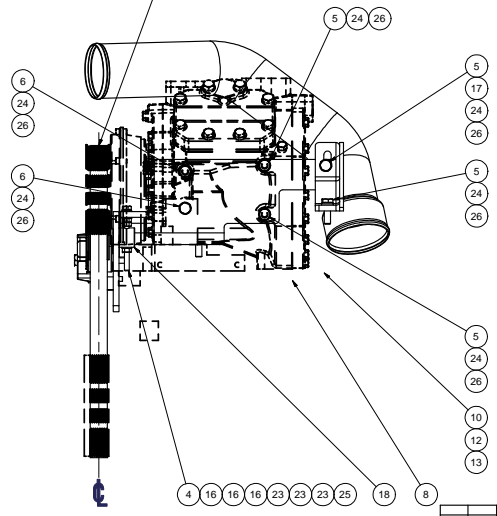
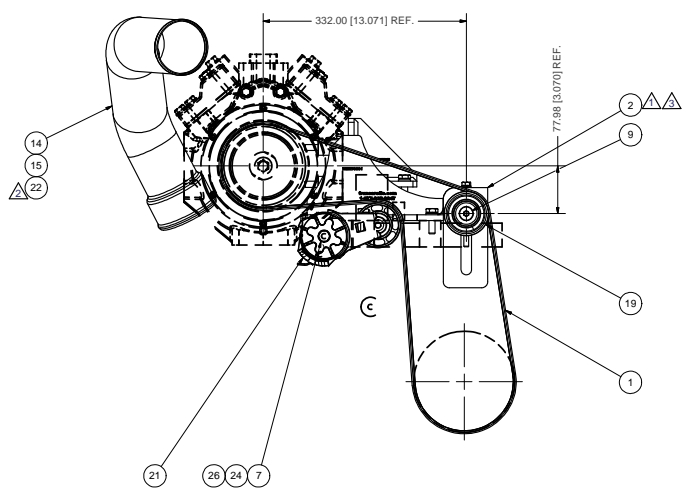

ITEM	QTY	U/M	PART NUMBER	DESCRIPTION
26	9	EACH	WLA10000	WASHER, LOCK, 10mm, 8.8, PLT
25	1	EACH	WLA08000	WASHER, LOCK, 8mm, 8.8, PLT
24	9	EACH	WFA10000	WASHER, FLAT, 10mm, 8.8, PLT
23	3	EACH	WFA08000	WASHER, FLAT, 8mm, 8.8, PLT
22	1	EACH	TUS04035	Tube, Stl, 3.5"/4" O.D. 8x5.75x5.25, 2x45 Deg
21	1	EACH	TEN80002	TENR, HD SPRING, BACKSIDE, CCW
20	1	EACH	SCD11617	SPACER, COL, DR, 11.6mm x 28.66 x 17l
19	1	EACH	PUL81074	PULLEY, IDLER, FRONTSIDE, P8, 74d x 39w
18	1	EACH	NTS10460	NUT, TENSIONER, 10mm, 49.21 mm o/a, PLT
17	1	EACH	NTA10000	NUT, HEX, 10 x 1.5, 8.8, PLT
16	3	EACH	NTA08000	NUT, HEX, 8 x 1.25, 8.8, PLT
15	1	EACH	HOA04045	HOSE, FLEX, CAC, ELB, SILICON, 4.0 x 45D
14	1	EACH	HOA03545	HOSE, FLEX, CAC, ELB, SILICON, 3.5 x 45D
13	1	EACH	HOA01125	HOSE, ELBOW, 1" ID, 12.5" O/A, 90 DEG
12	1	EACH	FTS16001	FTG, HOSE, SPLICE, 1" d, STL, PLT
11	1	EACH	CSF10031	CAPSCREW, FH, 10 x 1.5 x 30mm, 10.9, PLT
10	2	EACH	CLP16001	CLAMP, GEAR, #16, 15/16-1/2, S
9	1	EACH	BTS10001	BOLT, SHOULDER, 10mm (IDLER PULLEY)
8	1	EACH	BTS05100	BOLT, STUD, EXT, 5/16-18UNC, 1", PLT
7	1	EACH	BTC10080	BOLT, HEX, 10 x 1.5 x 80mm, 10.9, PLT
6	2	EACH	BTC10075	BOLT, HEX, 10 x 1.5 x 75mm, 10.9, PLT
5	6	EACH	BTC10035	BOLT, HEX, 10 x 1.5 x 35mm, 10.9, PLT
4	1	EACH	BTC08101	BOLT, HEX, 8 x 1.25 x 100mm, 10.9, PLT, FT
3	1	EACH	BMK70103	BKT, RR, BRACE, WELDMT, CAT, C7, F400.07
2	1	EACH	BMK70091	Bkt, Main, Weldmt, CAT C7, F400.07
1	1	EACH	BEL1664	Belt, 8gr, 1651mm (65.5") (5080655)

TRANSARGTIC INC.

REV	DESCRIPTION	DATE	BY
3	PNR BMK70091 BEEN MODIFIED	08/26/14	VAL
2	ADDED PNR VISCOUS	09/09/08	JRR
1	PNR BMK70091 BEEN MODIFIED	11/6/2008	JRR
0	RELEASED TO PRODUCTION	10/20/08	JRR

DRAWN: Jose Rodriguez 09/09/08
 CHECKED: Val Jakovlew 09/09/08
 DATE: 09/09/08
 BY: James Stewart
 APPROVED: Ron Ingram 09/09/08
 DATE: 09/09/08

NOTES:
1) USE SERVICABLE THREADLOCKER ON ALL FASTENERS TO ENGINE COMPONENTS AND TORQUE ALL BOLTS TO S.A.E. SPECIFICATIONS.
2) SEE "TRANSARGTIC A/C COMPRESSOR MOUNT INSTALLATION DISCLAIMER".

UNSPECIFIED TOLERANCES:	MM (INCH)	THIRD ANGLE PROJECTION	DRAWING UNIT OF MEASURE: MM (INCH)	SCALE: 1:2	SHEET 1 OF 1
ONE DECIMAL PLACE (X.1)	FRAC				
TWO DECIMAL PLACES (X.00)	FRAC				
THREE DECIMAL PLACES (X.000)	FRAC				
FRACTIONAL (1/16")	FRAC				

Mt Kit, C7, Vision, F400, 07

DWG NO: KMK72502

REV 3

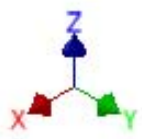
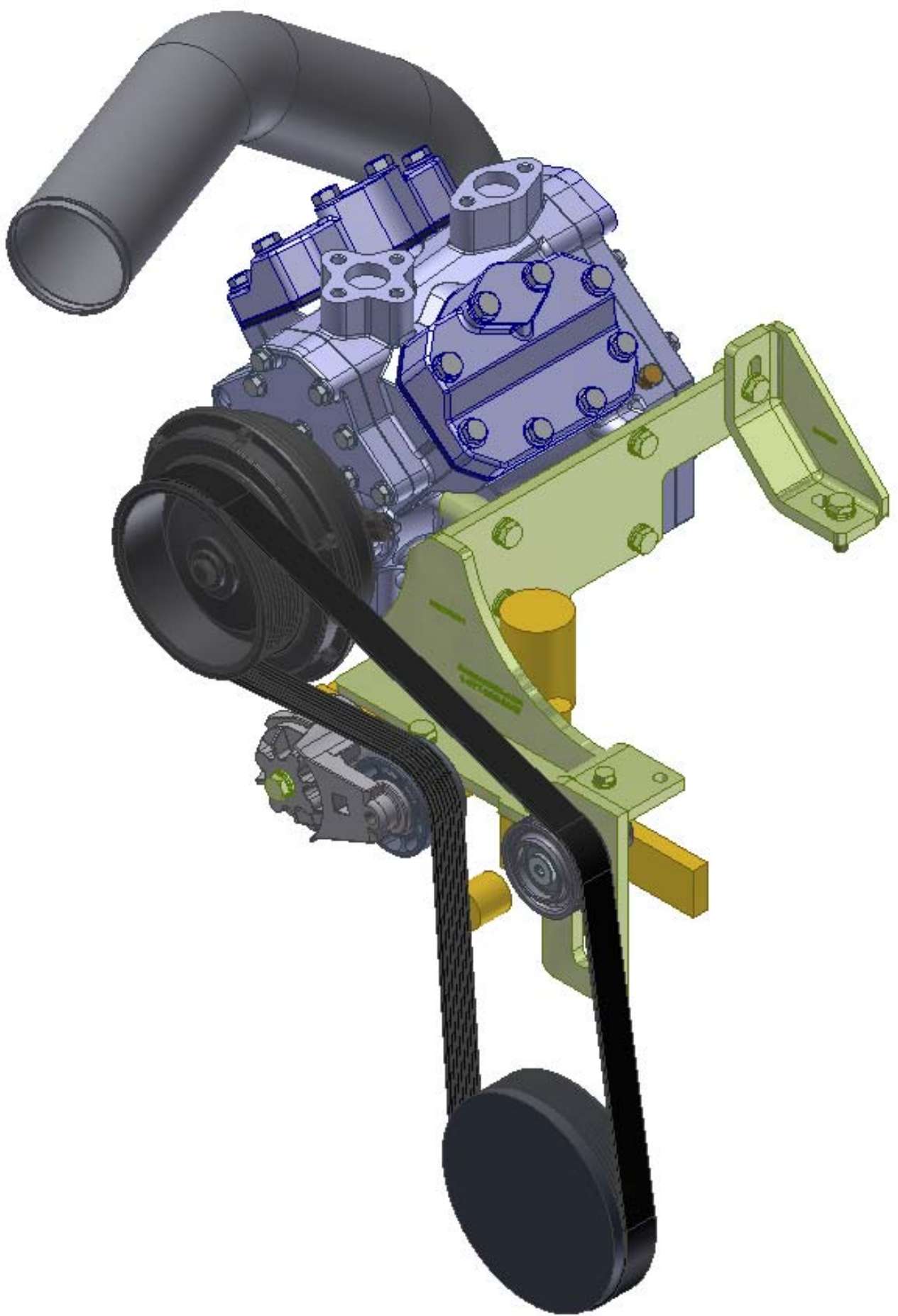

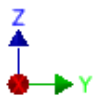
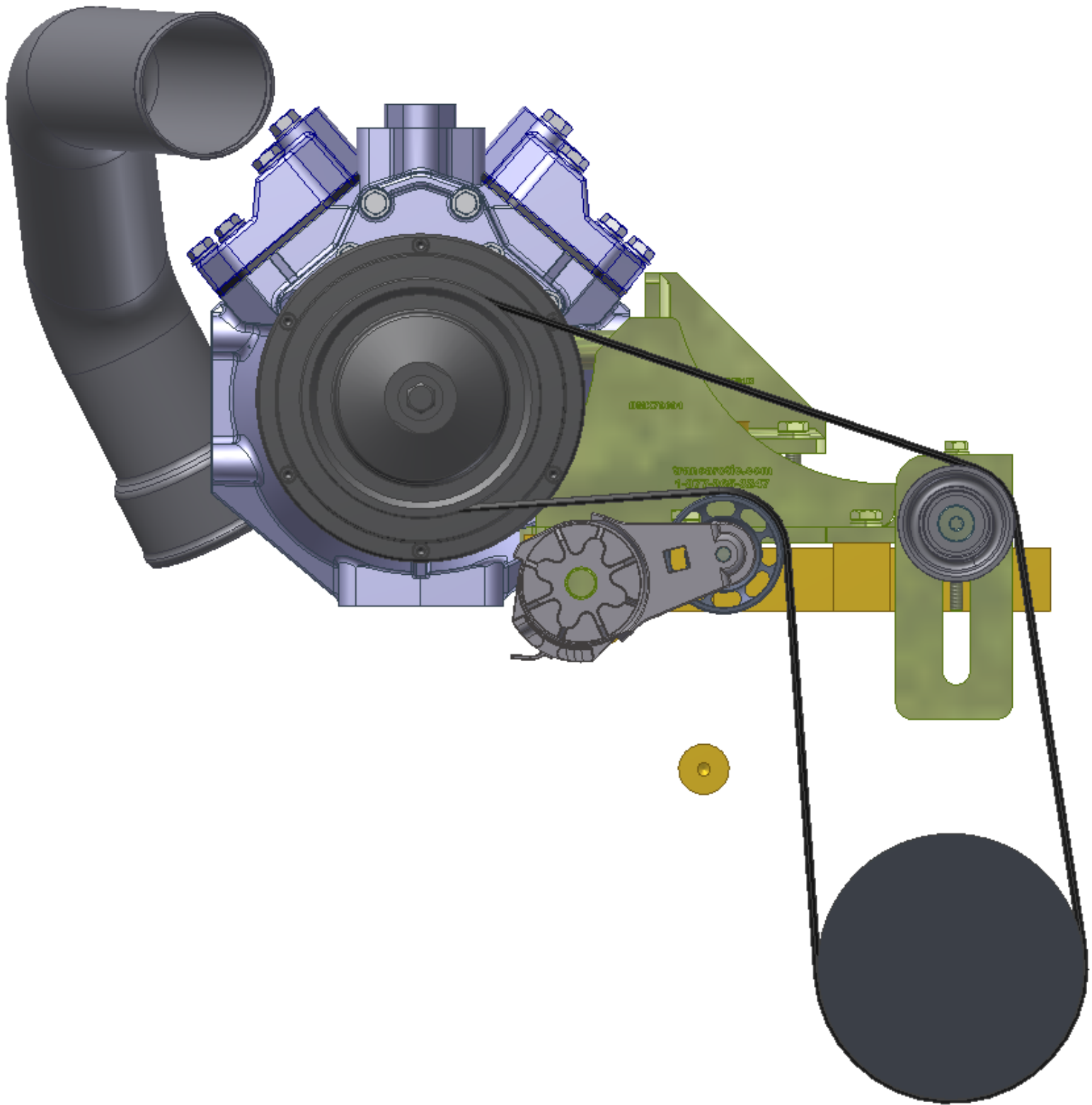

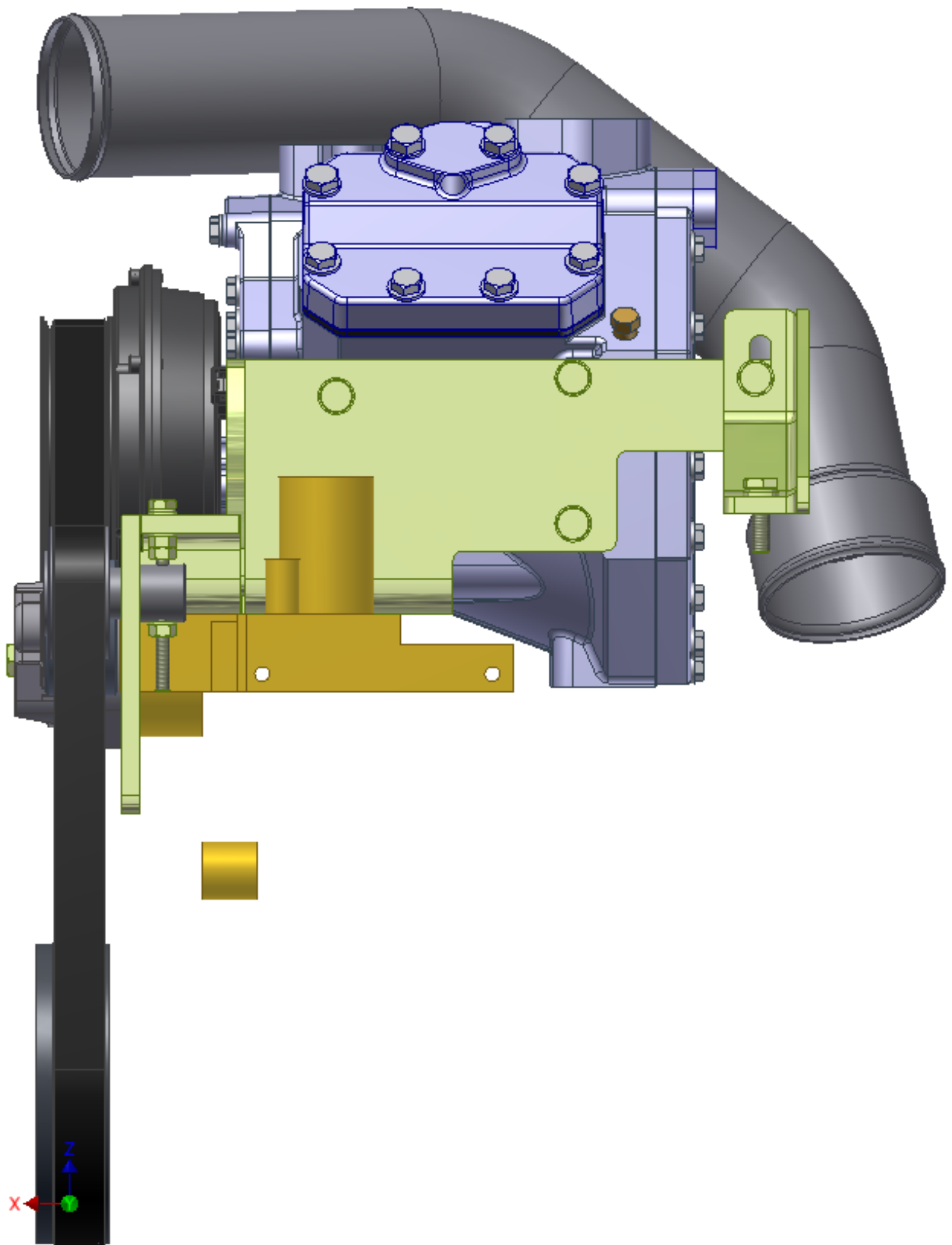

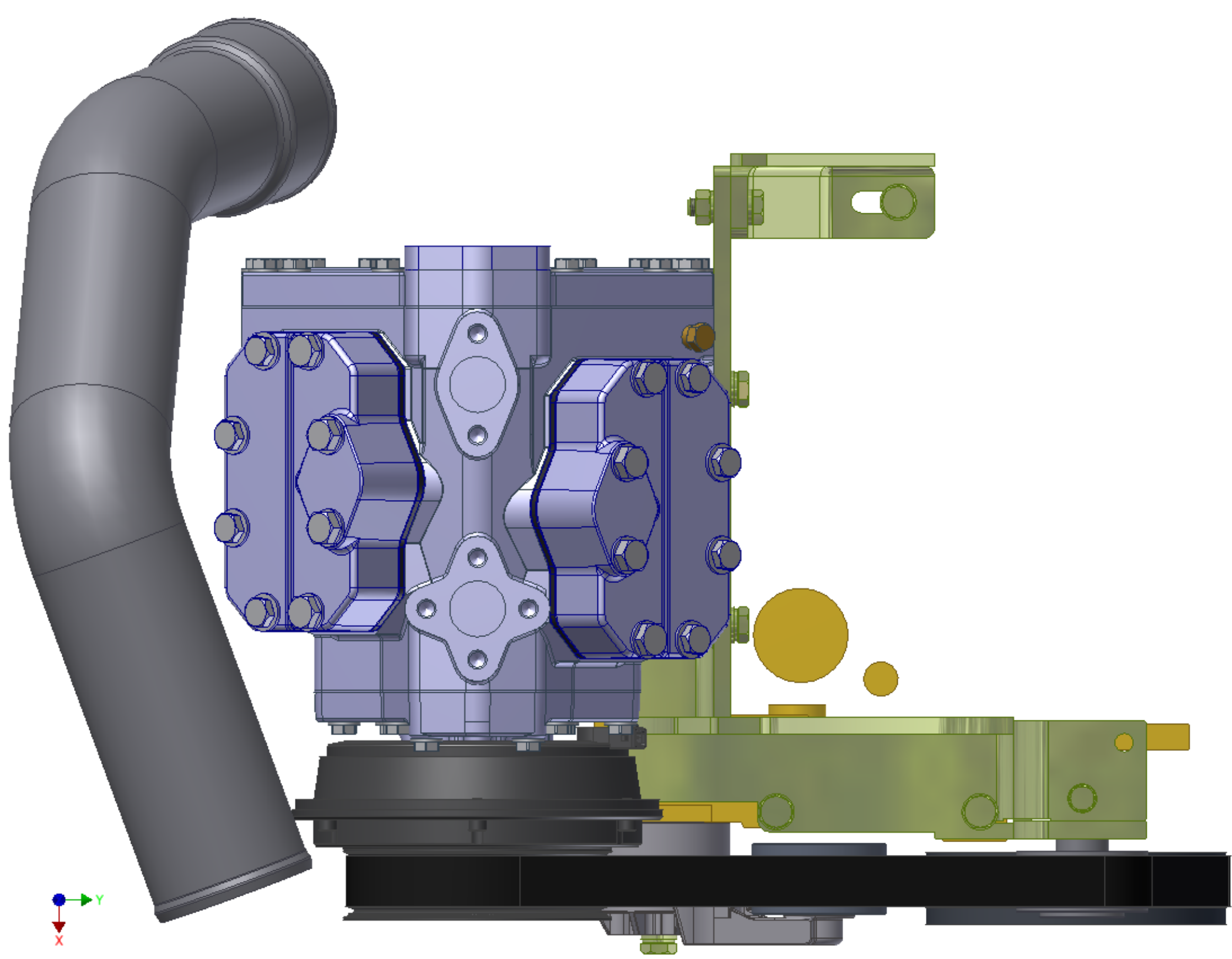

TransArctic A/C Compressor Mount Installation Disclaimer

All compressor mounts should be installed by qualified and trained personnel using proper tools and equipment in safe working conditions following industry standard guidelines for motor vehicle service and repair.

The installer of any compressor mount purchased from TransArctic must undertake all responsibility of issues arising from that compressor bracket being installed on any vehicle. As well as insure that a **proper and sufficient ground** is established between the compressors' clutches and the vehicle's engine. Mount functionality, operation and durability can all be compromised by an incompetent installation.

Due to the many different situations, parameters and application criteria, which are beyond the compressor mount manufacturer's control, TransArctic does not warrant design, durability, or operational functionality of any compressor mount improperly installed by another party.

With no implied guarantees it is the mount installer's strict responsibility to determine safety and functionality, of the compressor mount, at the time of installation.

Please contact TransArctic with any issue arising from installation so we may better improve the product. If you have any reservations about the compressor mount integrity contact TransArctic immediately at 1-877-COLD-AIR.

Mark OEM tensioner location

Install Kit

Check for Interferences

Check to ensure that the proper OEM tensioner orientation is maintained

Run engine with A/C system engaged for at least 10 minutes to run in belt

Check OEM tensioner orientation and adjust as required

Responsabilidad limitada de TransArctic en la instalación del soporte del compresor

Todos los soportes de los compresores deben ser instalados por personas calificadas y entrenadas, usando para ello los equipos y herramientas necesarios para esta labor en buenas condiciones y según las normas y guías para el servicio y/o reparación de motores de vehículos.

El instalador de los soportes comprados en TransArctic asume toda la responsabilidad de cualquier problema que surga en el soporte del compresor al vehículo; de igual manera es responsable que el cable a tierra sea conectado entre el embrague del compresor y el motor del vehículo.

Se advierte que el buen funcionamiento y la durabilidad del soporte pueden ser comprometidos por defectos en su instalación.

Debido a las diversas situaciones que se puedan presentar fuera del control del fabricante, TransArctic no garantiza el diseño, la durabilidad o el correcto funcionamiento de cualquier equipo inapropiadamente instalado por terceros.

Esta sobreentendido que el Instalador del montaje del compresor es estrictamente responsable de la seguridad y funcionamiento del equipo en el momento de la instalación.

Si tuviera algún problema o duda acerca de la instalación del soporte del compresor pongase en contacto inmediatamente con TransArctic al teléfono 1-877-COLD-AIR de modo que podamos mejorar nuestro producto.

Note la ubicación del medidor de tensión OEM

Instale el equipo

Controlar si hay interferencias.

Asegurese que el medidor de tensión mantenga la orientación justa.

Encienda el motor por lo menos 10 minutos con el sistema A/C enganchado para que la correa corra

Controle la orientación justa del medidor de tensión y ajuste a las condiciones requeridas del fabricante