

# Bill of Materials Listing

TransArctic Canada Inc.

4/13/2017  
Page 1 of 1

Product Number	Description	Date	Weight	Uof M	Yield
Line    Component    Prod#	Description	Bin                      Unit	Qty		
<b>KMC96695</b>	<b>Mt Kit, ISL-D, HDX, TM-55/65,24V,'16</b>		<b>113.30</b>		<b>0</b>
10	BEL32388				
	Belt, Banded B gr,2388mm (94") (RBX91-2)			each	1
20	BMC83125				
	Bkt, Weldm't, Adapter PI, ISL, HDX, '13			each	1
30	BMC90012				
	Bkt, Weldm't, Main Base, HDX, '16'			each	1
40	BMC90022				
	Bkt, Main, Idler, Weldm't, ISL, HDX, '16			each	1
50	KCB65501				
	Kit, Compressor, P/S, Alt, TM-65/55, '16			each	1
60	KPC89022				
	Kit, Pulley, ISL, 8.9L, 2B/X,'13			each	1
70	PUA05001				
	Pulley, Assy, Idler, B/S, 5", Stl, Plt			each	1
80	PUA05012				
	Pulley, Assy, Idler,B/BX gr,5", STL,Plt			each	1
85	SCD16012				
	Spacer, Col, Drl,16 mm x 34.9o x 12.3i			each	1
95	SCD21912				
	Spacer, Col, Drl,21.9mm x 25.4o x 12.3i			each	1
100	SLV17012				
	Sleeve, Pulley, 16.9o x 22.23mm x 12.32i			each	2
110	KBC96694				
	Bag Kit, Fasteners, KMC96694			each	1

# Bill of Materials Listing

TransArctic Canada Inc.

4/13/2017  
Page 1 of 1

Product Number	Description	Date	Weight	Uof M	Yield
Line Component Prod#	Description	Bin Unit	Qty		
<b>KBC96595</b>	<b>Bag Kit, Fasteners, KMC96595</b>	<b>11/21/2016</b>	<b>3.35</b>		<b>0</b>
10 BTC10045	Bolt, Hex, 10 x 1.5 x 45mm, 10.9, Plt,FT	each	3		
20 BTC12080	Bolt, Hex, 12 x 1.75 x 80mm, 10.9,Plt,FT	each	2		
30 BTP08653	Bolt, Hex, 1/2-13unc, 6.5", 5, Plt, FT	each	1		
40 BTQ06125	Bolt, Hex, 3/8-16unc, 1.25", 8, Plt	each	5		
50 BTQ08101	Bolt, Hex, 1/2-20unf, 1.00", 8, Plt	each	4		
60 BTQ08125	Bolt, Hex, 1/2-13unc, 1.25", 8, Plt	each	2		
70 BTQ08151	Bolt, Hex, 1/2-20unf, 1.5", 8, Plt	each	2		
80 CSF08076	Capscrew, FH, 1/2-20unf x .75",Alloy,Plt	each	2		
90 CSF08101	Capscrew, FH, 1/2-20unf x 1.0",Alloy,Plt	each	4		
100 NTA10000	Nut, Hex, 10 x 1.5, 8.8, Plt	each	3		
110 NTA12000	Nut, Hex, 12 x 1.75, 8.8, Plt	each	2		
120 NTQ06000	Nut, Hex, 3/8-16unc, 8, Plt	each	5		
130 WFA10002	Washer, Flat, 10mm, Hvy, 8.8, Plt	each	6		
140 WFA12002	Washer, Flat, 12mm, Hvy, 8.8, Plt	each	2		
150 WFQ08000	Washer, Flat, 1/2", 8, Plt	each	8		
160 WFS06002	Washer, Flat, 3/8", L9, Plt	each	10		
170 WLA10000	Washer, Lock, 10mm, 8.8, Plt	each	3		
180 WLA12000	Washer, Lock, 12mm, 8.8, Plt	each	2		
190 WLQ06000	Washer, Lock, 3/8", 8, Plt	each	5		
200 WLQ08000	Washer, Lock, 1/2", 8, Plt	each	9		

# Bill of Materials Listing

TransArctic Canada Inc.

2/4/2022  
Page 1 of 1

Product Number	Date	Description		Uof M	Weight	Yield
Line	Qty	Component Prod#	Rev#	Description	Bin	Unit
<b>KCB65501</b>	<b>08/10/16</b>	<b>2 Kit, Compressor, P/S, Alt, TM-65/55, '16</b>			<b>166.11</b>	<b>0</b>
10	2	BMN80008	1	Vibration Isolator, Bar, 16.50 x 2 x 1.50		each
20	1	BMN80025	0	Bkt, Back, PL, Slide, IC, RE300		each
30	1	BMZ00043	3	Bkt, Main, Base Pl, '13		each
40	1	BTP08653		Bolt, Hex, 1/2-13unc, 6.5", 5, Plt, FT		each
50	3	BTQ08101		Bolt, Hex, 1/2-20unf, 1.00", 8, Plt		each
60	3	CSF08076		Capscrew, FH, 1/2-20unf x .75", Alloy, Plt		each
70	1	KAC65501	3	Kit, Alternator, TM-65, Curb Side, '13		each
80	1	KBT65501	0	Kit, Platform, P/S, TM-55/65, '16		each
90	3	WFQ08000		Washer, Flat, 1/2", 8, Plt		each
100	4	WLQ08000		Washer, Lock, 1/2", 8, Plt		each

# Bill of Materials Listing

TransArctic Canada Inc.

2/4/2022  
Page 1 of 1

Product Number	Date	Description		Uof M	Weight	Yield	
Line	Qty	Component Prod#	Rev#	Description	Bin	Unit	
<b>KAC65501</b>	<b>08/10/16</b>		<b>3</b>	<b>Kit, Alternator, TM-65, Curb Side, '13</b>		<b>45.31</b>	<b>0</b>
10	2	BEL11040		Belt, A gr, 1040mm (41")		each	
20	1	BMC90020	A	Bkt, Alt, Weldm't, Curb Side, TM65/55, '16		each	
30	2	BMT10011	0	Bkt, Tenr, Block, Offset, 3mm		each	
40	1	PUL03321	1	Pulley, ALT, Idler, 3.25"d, 2A		each	
45	1	KBA84064	0	Bag Kit, ALT Shim, KC84064, KAC65501/02		each	
47	1	SCD05513	0	Spacer, Col, Drl, 5.51mm x 25.4o x12.7i	Alley	each	
50	1	TRD08080		Threaded, Rod, 1/2-13unc x 8", 5, Plt		each	
60	1	KBA65501	0	Bag Kit, Fasteners, KAC65501		each	

**NOTE:**

1) Use KBA84064 "Shim bag kit", as required, to align the Alternator correctly.

# Bill of Materials Listing

TransArctic Canada Inc.

2/4/2022  
Page 1 of 1

Product Number	Date	Description	Uof M	Weight	Yield			
Line	Qty	Component Prod#	Rev#	Description	Bin	Unit	Weight	Yield
<b>KBA65501</b>	<b>08/10/16</b>	<b>0</b>		<b>Bag Kit, Fasteners, KAC65501</b>			<b>1.45</b>	<b>0</b>
10	4	BTC12035		Bolt, Hex, 12 x 1.75 x 35mm, 10.9,Plt,FT		each		
20	1	BTQ08125		Bolt, Hex, 1/2-13unc, 1.25", 8, Plt		each		
30	1	BTQ08150		Bolt, Hex, 1/2-13unc, 1.5", 8, Plt		each		
40	1	BTQ08653		Bolt, Hex, 1/2-13unc, 6.5", 8, Plt		each		
50	6	NTQ08000		Nut, Hex, 1/2-13unc, 8, Plt		each		
60	4	WFA12000		Washer, Flat, 12mm, 8.8, Plt		each		
70	3	WFQ08000		Washer, Flat, 1/2", 8, Plt		each		
80	4	WLA12000		Washer, Lock, 12mm, 8.8, Plt		each		
90	4	WLQ08000		Washer, Lock, 1/2", 8, Plt		each		

# Bill of Materials Listing

TransArctic Canada Inc.

2/4/2022  
Page 1 of 1

Product Number	Date	Description			Uof M	Weight	Yield		
Line	Qty	Component	Prod#	Rev#	Description	Bin	Unit		
<b>KBA84064</b>	<b>10/19/21</b>	<b>0</b>			<b>Bag Kit, ALT Shim, KC84064, KAC65501/02</b>			<b>0.09</b>	<b>0</b>
10	1	SCD03613		0	Spacer, Col, Drl, 3.56mm x 25.4o x12.7i	Alley	each		
20	2	WFA14000			Washer, Flat, 14mm, 8.8, Plt		each		
30	2	WFQ08000			Washer, Flat, 1/2", 8, Plt		each		

**NOTE:**

1) Use (1) SCD03613, (2) WFA14000, (2) WFQ08000, in any arrg'mt/qtys as required to align the Alternator correctly.

# Bill of Materials Listing

TransArctic Canada Inc.

8/11/2016  
Page 1 of 1

Product Number	Description	Date	Weight	Uof M	Yield
Line    Component    Prod#	Description	Bin                    Unit	Qty		
<b>KBT65501</b>	<b>Kit, Platform, TM-55/65, '16</b>		<b>8/10/2016</b>	<b>17.04</b>	<b>0</b>
10 BMN80031	Bkt, Main, Slide, Assy, 05K, IC, RE300		each	1	
20 BMZ00039	Bkt, Comp, Rear, TM-65, '12		each	1	
30 BMZ00040	Bkt, Comp, FRT, TM-65, '12		each	1	
40 KBZ65501	Bag Kit, Fasteners, KBT65501		each	1	

# Bill of Materials Listing

TransArctic Canada Inc.

8/11/2016  
Page 1 of 1

Product Number	Description	Date	Weight	Uof M	Yield
Line    Component    Prod#	Description	Bin                    Unit	Qty		
<b>KBZ65501</b>	<b>Bag Kit, Fasteners, KBT65501</b>		<b>8/10/2016</b>	<b>0.69</b>	<b>0</b>
10	BTC12035		Bolt, Hex, 12 x 1.75 x 35mm, 10.9,Plt,FT	each	4
20	NTP07000		Nut, Hex, 7/16-14unc, 5, Plt	each	4
30	WFA12000		Washer, Flat, 12mm, 8.8, Plt	each	4
40	WFN07000		Washer, Flat, 7/16", 2, Plt	each	4
50	WLA12000		Washer, Lock, 12mm, 8.8, Plt	each	4
60	WLQ07000		Washer, Lock, 7/16", 8, Plt	each	4



# Bill of Materials Listing

TransArctic Canada Inc.

8/11/2016

Page 1 of 1

Product Number		Description	Bin	Date	Weight	Uof M	Yield
Line	Component Prod#	Description		Unit	Qty		
<b>KPC89022</b>		<b>Kit, Pulley, ISL, 8.9L, 2B/X,'13</b>		<b>10/15/2013</b>	<b>11.51</b>		<b>0</b>
10	PUL89022	Pulley, Crank, ISL, 8.9L, 2B/X, 8", '13		each	1		
20	BTC10050	Bolt, Hex, 10 x 1.5 x 50mm, 10.9, Plt		each	5		
30	WFA10000	Washer, Flat, 10mm, 8.8, Plt		each	5		

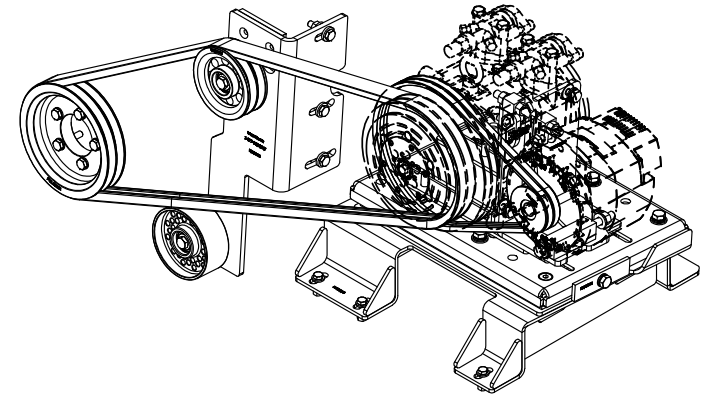
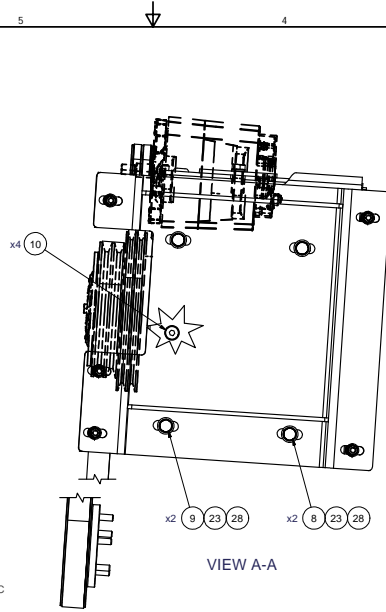
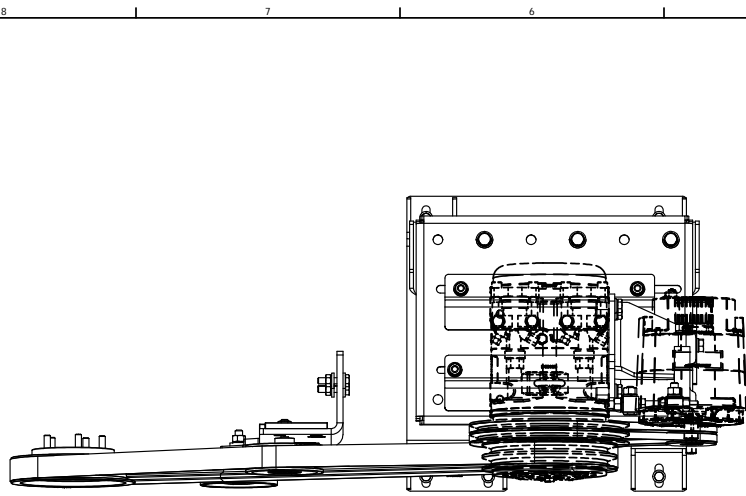

ISOMETRIC VIEW

NOTE:  
SHOWING TRANSARC TIC  
COMPRESSOR PART#  
CMV38644 (TM-55/  
CMV38844(TM-65)  
AS REFERENCE.

NOTE:  
SHOWING ALTERNATOR  
AS REFERENCE.

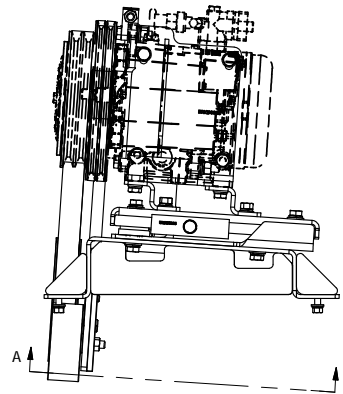
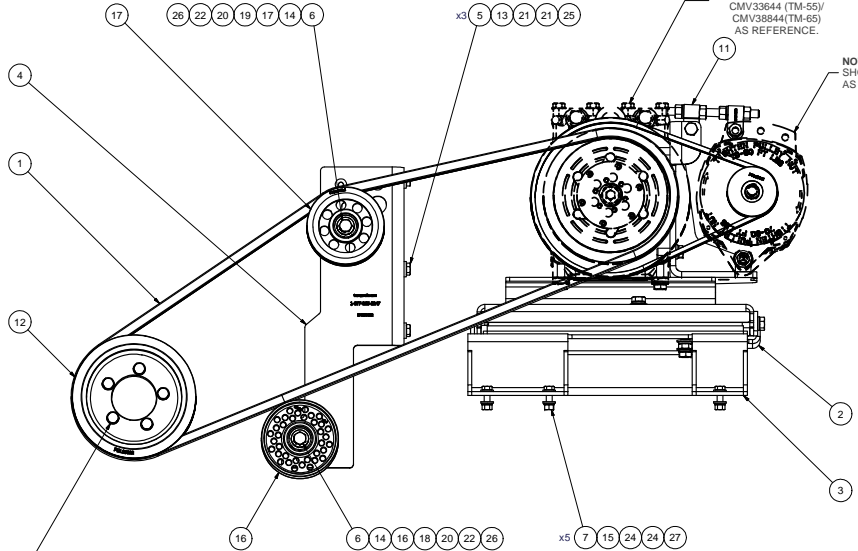

NOTE:  
TORQUE TO: 48 FT-LB PLAIN & LUBRICATED W/ CLEAN ENGINE OIL (15W-40)  
(HEXBOLT CAPSCREW M10 x 1.5 x 50mm)  
TIGHTEN IN TWO STEPS IN A CRIS-CROSS TIGHTENING SEQUENCE PATTERN.

NOTES:

- 1) USE SERVICABLE THREADLOCKER ON ALL FASTENERS TO ENGINE COMPONENTS AND TORQUE ALL BOLTS TO S.A.E. SPECIFICATIONS.
- 2) SEE 'TRANSARC TIC AC COMPRESSOR MOUNT INSTALLATION DISCLAIMER'.

ITEM	QTY	U/M	PART NUMBER	DESCRIPTION
28	4	EACH	WLO08000	WASHER, LOCK, 1/2", 8, PLT
27	5	EACH	WLO06000	WASHER, LOCK, 3/8", 8, PLT
26	2	EACH	WLA12000	WASHER, LOCK, 12mm, 8.8, PLT
25	3	EACH	WLA10000	WASHER, LOCK, 10mm, 8.8, PLT
24	10	EACH	WFS06002	WASHER, FLAT, 3/8", L9, PLT
23	4	EACH	WFO08000	WASHER, FLAT, 1/2", 8, PLT
22	2	EACH	WFA12002	WASHER, FLAT, 12mm, HVY, 8.8, PLT
21	6	EACH	WFA10002	WASHER, FLAT, 10mm, HVY, 8.8, PLT
20	2	EACH	SLV17012	SLEEVE, PULLEY, 16.90 x 22.23 mm x12.19
19	1	EACH	SCD21912	SPACER, COL, DRL, 21.9mm x 31.80 x12.31
18	1	EACH	SCD16012	SPACER, COL, DRL, 16 mm x 31.80 x 12.01
17	1	EACH	PUA05012	PULLEY, ASSY, IDLER, B/BX gr, 5" STL, PLT
16	1	EACH	PUA05001	PULLEY, ASSY, IDLER, B/S, 5", STL, PLT
15	5	EACH	NTQ06000	NUT, HEX, 3/8-16UNC, 8, PLT
14	2	EACH	NTA12000	NUT, HEX, 12 x 1.75, 8.8, PLT
13	3	EACH	NTA10000	NUT, HEX, 10 x 1.5, 8.8, PLT
12	1	EACH	KPC89022	KIT, PULLEY, ISL, 8.9L, 2B/X, '13
11	1	EACH	KCB8501	KIT, COMPRESSOR, P/S, ALT, TM-45/55, '16
10	4	EACH	CSF08101	CAPSCREW, FH, 1/2-20UNF x 1", ALLOY, PLT
9	2	EACH	BTQ08151	BOLT, HEX, 1/2-20UNF x 1.50, 8, PLT
8	2	EACH	BTQ08125	BOLT, HEX, 1/2-13UNC x 1.25, 8, PLT
7	5	EACH	BTQ06125	BOLT, HEX, 3/8-16UNC x 1.25, 8, PLT
6	2	EACH	BTC12080	BOLT, HEX, 12 x 1.75 x 80mm, 10.9, PLT
5	3	EACH	BTC10045	BOLT, HEX, 10 x 1.5 x 45mm, 10.9, PLT
4	1	EACH	BMC90022	BKT, MAIN, IDLER, WELDMT, ISL, HDX, '16
3	1	EACH	BMC90012	BKT, WELDMT, MAIN BASE, HDX, '16
2	1	EACH	BMC83125	BKT, WELDMT, ADAPTER PL, ISL, HDX, '13
1	1	EACH	BEL32388	BELT, BANDED B gr, 2388mm ('04')

BILL OF MATERIALS

BROWN	11/17/2016	
JRodriguez		
CHECKED		
Vval_Jakowlew	11/17/2016	
GA		
JJames Stewart	11/17/2016	
MFS		
Ron Ingram	11/17/2016	
APPROVED		
Dale Mason	11/17/2016	

**TRANSARC TIC INC.**

MT KIT, ISL-D, HDX, TM-55/ 65, 24V, '16

UNSPECIFIED TOLERANCES:	ALL DIMS	
ONE DECIMAL PLACE (X0)	0.05	FRACTIONAL
TWO DECIMAL PLACE (X00)	0.005	FRACTIONAL
THREE DECIMAL PLACE (X000)	0.0005	FRACTIONAL
FRACTIONAL (X1/16)	1/32	FRACTIONAL



DRAWING UNIT OF MEASURE: MM (INCH)

SIZE: D DWG NO: KMC96695 REV: 0  
SCALE: 1:4 SHEET 1 OF 1

**TOP VIEW**

PARTS REMOVED FOR CLARITY.

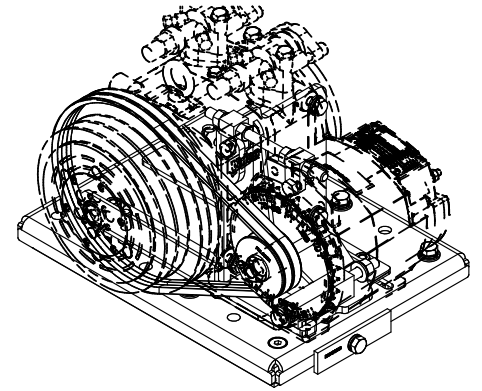
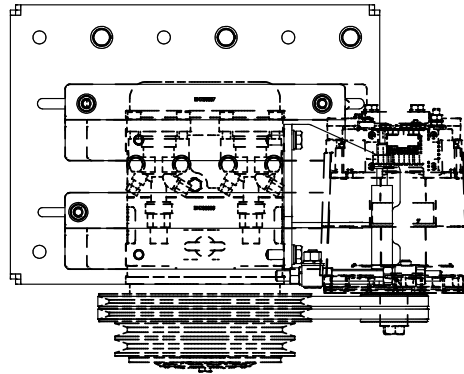
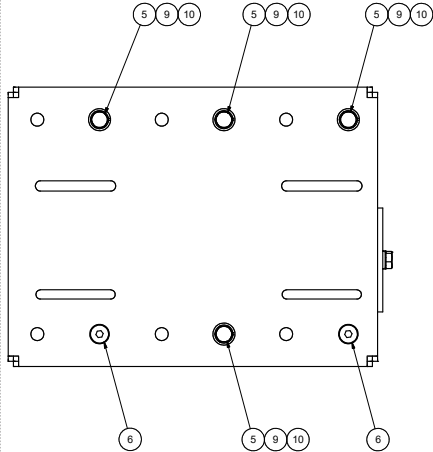

ISOMETRIC VIEW

NOTE:  
SHOWING TRANSARCTIC  
COMPRESSOR PART#  
CMV33644 (TM-55)  
CMV33844 (TM-65)  
AS REFERENCE.

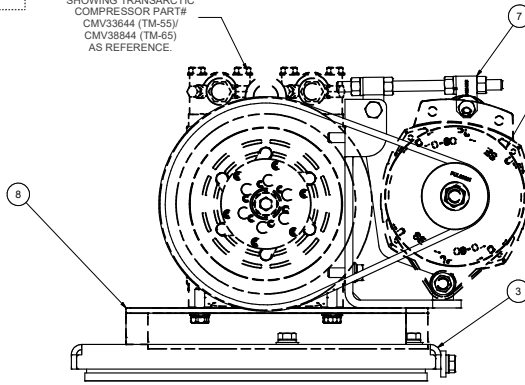

NOTE:  
SHOWING ALTERNATOR  
AS REFERENCE.

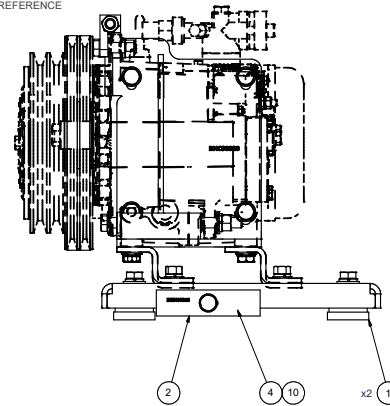

NOTES:

- 1) USE SERVICABLE THREADLOCKER ON ALL FASTENERS TO ENGINE COMPONENTS AND TORQUE **ALL** BOLTS TO S.A.E. SPECIFICATIONS.
- 2) SEE 'TRANSARCTIC A/C COMPRESSOR MOUNT INSTALLATION DISCLAIMER'.
- 3) WEIGHT: 68.75 LBS.

ITEM	QTY	U/M	PART NUMBER	DESCRIPTION
10	5	EACH	IWLQ08000	WASHER, LOCK, 1/2", 8, PLT
9	4	EACH	WFC08000	WASHER, FLAT, 1/2", 8, PLT
8	1	EACH	KBT65501	KIT, PLATFORM, P/S, TM-55/65, '16
7	1	EACH	KAC65501	KIT, ALTERNATOR, TM-65, CURB SIDE, '13
6	2	EACH	CSF08076	CAPSCREW, FH, 1/2-20UNF x .75", ALLOY, PLT
5	4	EACH	BTQ08101	BOLT, HEX, 1/2-20UNF x 1.00, 8, PLT
4	1	EACH	BTP08653	BOLT, HEX, 1/2-13UNC x 6.50, 5, PLT, FT
3	1	EACH	BMZ00043	BKT, MAIN, BASE PL, '13
2	1	EACH	BMN80025	BKT, BACK, PL, SLIDE, IC, RE300
1	2	EACH	BMN80008	VIBRATION ISOLATOR, BAR, 16.50 x 2 x 1.50

DRAWN				CHECKED				TITLE			
vjakowlew				8/3/2016				TRANSARCTIC INC.			
0				RELEASED TO PRODUCTION				8/3/2016			
REV: ECN				DESCRIPTION:				DATE:			
1				REVISED KAC65501				11/2/2016			
0				RELEASED TO PRODUCTION				8/3/2016			
BY: Dale Mason				DATE: 8/3/2016				BY: Jose Rodriguez			
DATE: 8/3/2016				DATE: 8/3/2016				BY: James Stewart			
APPROVED				APPROVED				DATE: 8/3/2016			
DATE: 8/3/2016				DATE: 8/3/2016				DATE: 8/3/2016			
UNSPECIFIED TOLERANCES:				ALL DIMS				DWG NO			
ONE DECIMAL PLACE (X1)				.005				KCB65501			
TWO DECIMAL PLACE (X2)				.002				REV			
THREE DECIMAL PLACE (X3)				.001				1			
FRACTIONAL (X1/16)				.0005				SCALE			
THIRD ANGLE PROJECTION				DRAWING UNIT OF MEASURE:				MM (INCH)			
				SCALE				1:3			
				SHEET				1 OF 1			

REV	ECN	DESCRIPTION	DATE	BY
1		REVISED KAC65501	11/2/2016	JRR
0		RELEASED TO PRODUCTION	8/3/2016	JRR

UNSPECIFIED TOLERANCES:  
ONE DECIMAL PLACE (X1) .005  
TWO DECIMAL PLACE (X2) .002  
THREE DECIMAL PLACE (X3) .001  
FRACTIONAL (X1/16) .0005



DRAWING UNIT OF MEASURE: MM (INCH)  
SCALE: 1:3

SHEET 1 OF 1

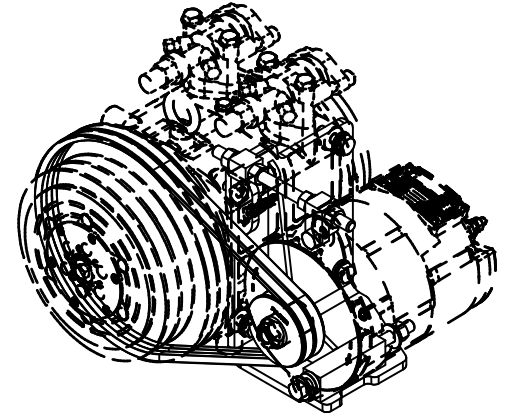
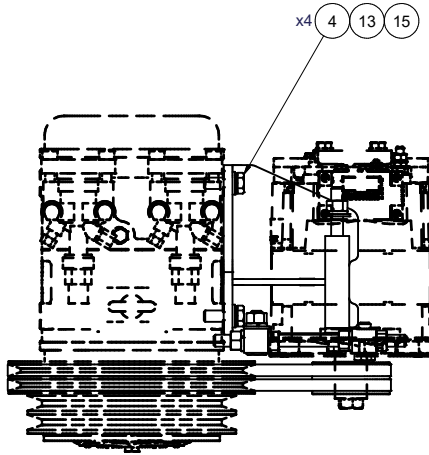

ISOMETRIC VIEW

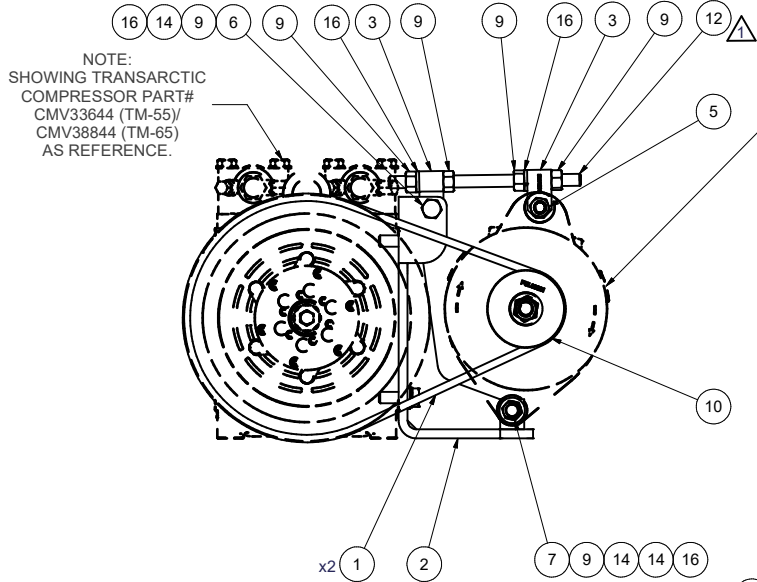

NOTE:  
SHOWING TRANSARCTIC  
COMPRESSOR PART#  
CMV33644 (TM-55/  
CMV38844 (TM-65)  
AS REFERENCE.

NOTE:  
SHOWING ALTERNATOR  
AS REFERENCE

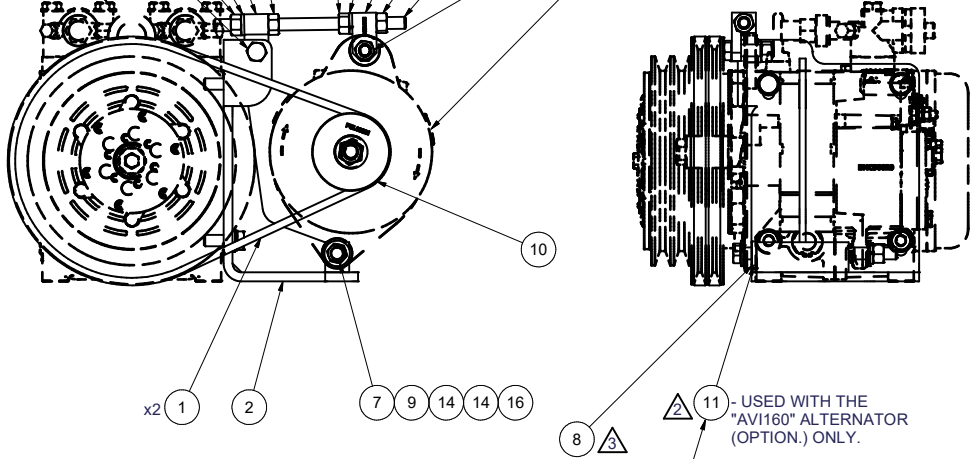

USE KBA84064 SHIM KIT AS REQUIRED  
TO ALIGN ALTERNATOR PULLEY TO  
COMPRESSOR PULLEY "A" GROOVES.

11 - USED WITH THE  
"AVI160" ALTERNATOR  
(OPTION.) ONLY.

NOTES:

- 1) USE SERVICABLE THREADLOCKER ON ALL FASTENERS TO ENGINE COMPONENTS AND TORQUE **ALL** BOLTS TO S.A.E. SPECIFICATIONS.
- 2) SEE "TRANSARCTIC A/C COMPRESSOR MOUNT INSTALLATION DISCLAIMER".
- 3) WEIGHT: 18.11 LB

16	4	EACH	WLQ08000	WASHER, LOCK, 1/2", 8, PLT
15	4	EACH	WLA12000	WASHER, LOCK, 12mm, 8.8, PLT
14	3	EACH	WFO08000	WASHER, FLAT, 1/2", 8, PLT
13	4	EACH	WFA12000	WASHER, FLAT, 12mm, 8.8, PLT
12	1	EACH	TRD08080	THREADED, ROD, 1/2-13UNC x 8", 5 PLT
11	1	EACH	SCD05513	SPACER, COL, DRL, 5.51mm x 25.4o x 12.7i
10	1	EACH	PUL03321	PULLEY, ALT, IDLER, 3.25"o, 2A
9	6	EACH	NTQ08000	NUT, HEX, 1/2-13UNC, 8, PLT
8	1	EACH	KBA84064	BAG KIT, ALT SHIM, KC84064, KAC65501/02
7	1	EACH	BTQ08653	BOLT, HEX, 1/2-13UNC x 6.50, 8, PLT
6	1	EACH	BTQ08150	BOLT, HEX, 1/2-13UNC x 1.50, 8, PLT
5	1	EACH	BTQ08125	BOLT, HEX, 1/2-13UNC x 1.25, 8, PLT
4	4	EACH	BTC12035	BOLT, HEX, 12 x 1.75 x 35mm, 10.9, PLT
3	2	EACH	BMT10011	BKT, TENR, BLOCK, OFFSET, 3mm
2	1	EACH	BMC90020	BKT, ALT, WELDM'T, CURB SIDE, TM-65/55, '16
1	2	EACH	BEL11040	BELT, A gr, 1040mm (41")
ITEM	QTY	U/M	PART NUMBER	DESCRIPTION

BILL OF MATERIALS

3	ADDED KBA84064 SHIM BAG KIT.	02/03/2022	VALJ	
2	ADDED SCD05513.	05/11/2021	JRR	
1	WAS TRD08060, NOW TRD08080	10/2/2018	JRR	
0	RELEASED TO PRODUCTION.	8/3/2016	JRR	
REV:	ECN:	DESCRIPTION:	DATE:	BY:
THIS DRAWING CONTAINS PROPRIETARY CONFIDENTIAL INFORMATION OWNED BY TRANSARCTIC CANADA INC. THE DOCUMENT AND THE INFORMATION IN IT ARE NOT TO BE USED, DISCLOSED OR REPRODUCED WITHOUT EXPRESS WRITTEN PERMISSION OF THE COMPANY.				
UNSPECIFIED TOLERANCES: [ALT. DIM.]				
ONE DECIMAL PLACE (X)	MM	(INCH)		
TWO DECIMAL PLACE (XX)	.50	[.005]		
THREE DECIMAL PLACE (XXX)	.25	[.010]		
FRACTIONAL (1/16")	.10	[.005]		
	ANGULAR	+/- .50		
THIRD ANGLE PROJECTION				
DRAWN		08/03/16		
vjakowlew				
CHECKED				
Jose Rodriguez		08/03/16		
MFG		08/03/16		TITLE <b>KIT, ALTERNATOR, TM-55/65, CURB SIDE, '13</b>
James Stewart		08/03/16		
APPROVED				
Dale Mason		08/03/16		SIZE <b>C</b>
DRAWING UNIT OF MEASURE:		MM [INCH]		DWG NO <b>KAC65501</b>
SCALE		1:4		REV <b>3</b>
SHEET		1 OF 1		

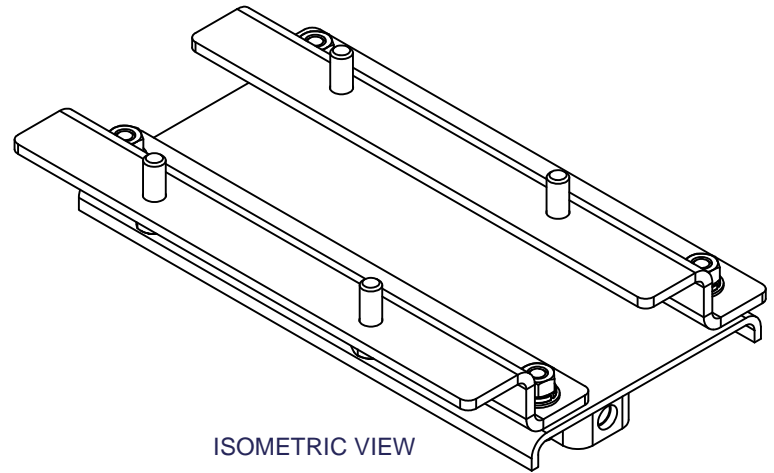
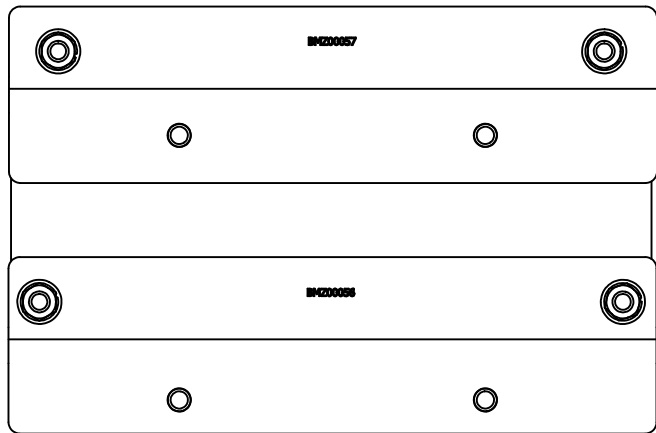

ISOMETRIC VIEW

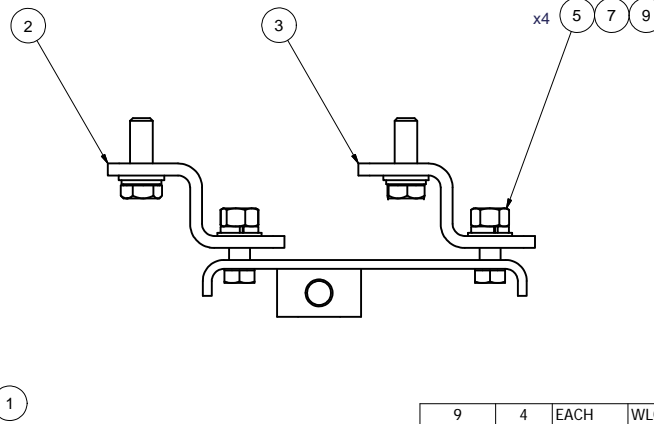
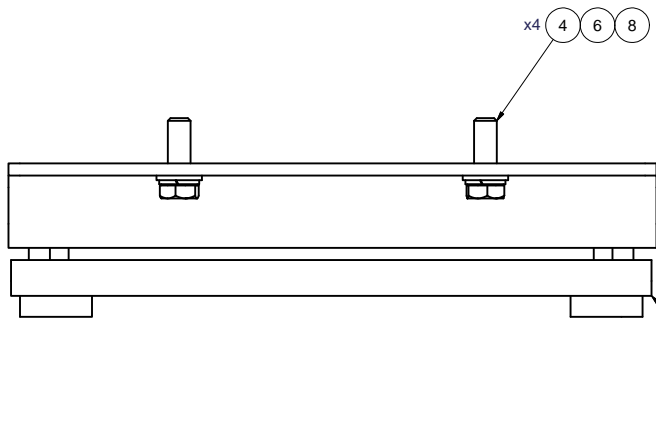

**NOTES:**

- 1) USE SERVICABLE THREADLOCKER ON ALL FASTENERS TO ENGINE COMPONENTS AND TORQUE **ALL** BOLTS TO S.A.E. SPECIFICATIONS.
- 2) SEE "TRANSARCTIC A/C COMPRESSOR MOUNT INSTALLATION DISCLAIMER".
- 3) WEIGHT: 16.47 LBS.

ITEM	QTY	U/M	PART NUMBER	DESCRIPTION
9	4	EACH	WLQ07000	WASHER, LOCK, 7/16", 8, PLT
8	4	EACH	WLA12000	WASHER, LOCK, 12mm, 8.8, PLT
7	4	EACH	WFN07000	WASHER, FLAT, 7/16", 2, PLT
6	4	EACH	WFA12000	WASHER, FLAT, 12mm, 8.8, PLT
5	4	EACH	NTP07000	NUT, HEX, 7/16-14UNC, 5, PLT
4	4	EACH	BTC12035	BOLT, HEX, 12 x 1.75 x 35mm, 10.9, PLT
3	1	EACH	BMZ00057	BKT, COMP, REAR, Z, TM-65/55, '13
2	1	EACH	BMZ00056	BKT, COMP, FRT, Z, TM-65/55, '13
1	1	EACH	BMN80031	BKT, MAIN, SLIDE, ASSY, 05K, IC, RE300

**BILL OF MATERIALS**

DRAWN	jrodriguez	8/8/2016	<b>TRANSARCTIC INC.</b>
CHECKED	Val Jakowlew	8/8/2016	
APPROVED	James Stewart	8/8/2016	
MFG	James Stewart	8/8/2016	
TITLE			<b>KIT, PLATFORM, P/S, TM-55/65, '16</b>
DRAWING UNIT OF MEASURE:			
SIZE	C	DWG NO	REV
SCALE	1:2	KBT65501	0
SHEET 1 OF 1			

0	-	RELEASED TO PRODUCTION	8/8/2016	JRR
REV	ECN	DESCRIPTION	DATE	BY
THIS DRAWING CONTAINS PROPRIETARY CONFIDENTIAL INFORMATION OWNED BY TRANSARCTIC CANADA INC. THE DOCUMENT AND THE INFORMATION IN IT ARE NOT TO BE USED, DISCLOSED OR REPRODUCED WITHOUT EXPRESS WRITTEN PERMISSION OF THE COMPANY.				
UNSPECIFIED TOLERANCES: (ALT. DIM.)				
ONE DECIMAL PLACE (.X)	MM	(.020)	[.020]	
TWO DECIMAL PLACE (.XX)	MM	(.010)	[.010]	
THREE DECIMAL PLACE (.XXX)	MM	(.005)	[.005]	
FRACTIONAL +/- 1/32"	ANGULAR	+/- .50°		
THIRD ANGLE PROJECTION				

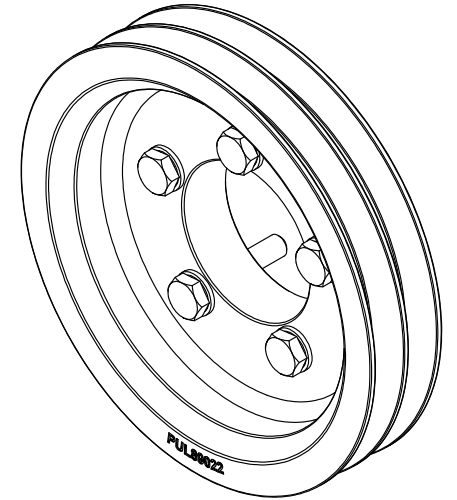
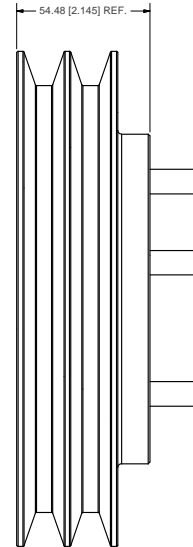
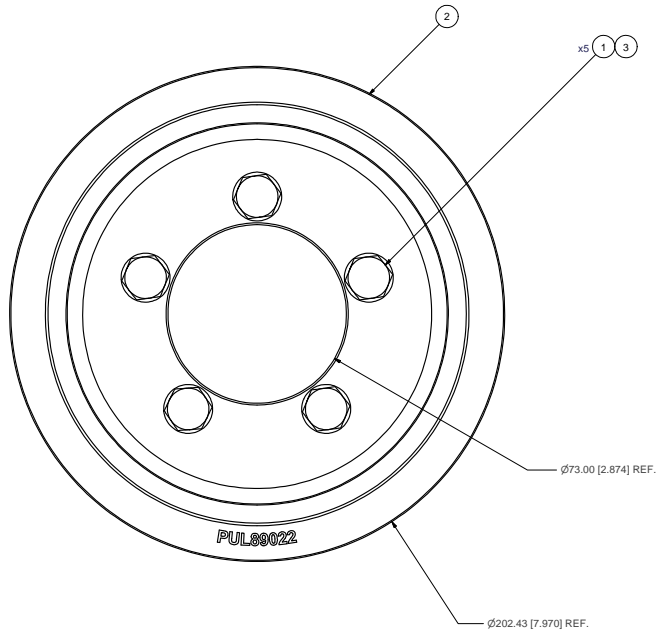
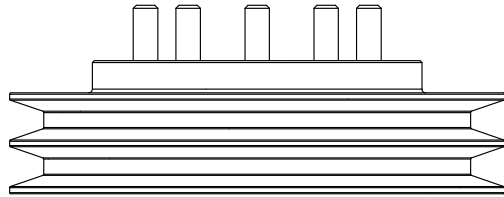

ISOMETRIC VIEW

- NOTES:**
- 1) USE SERVICABLE THREADLOCKER ON ALL FASTENERS TO ENGINE COMPONENTS AND TORQUE ALL BOLTS TO S.A.E. SPECIFICATIONS.
  - 2) SEE "TRANSARCTIC A/C COMPRESSOR MOUNT INSTALLATION DISCLAIMER".
  - 3) WT:≈ 11.56 LBS

ITEM	QTY	U/M	PART NUMBER	DESCRIPTION
3	5	EACH	WFA10000	WASHER, FLAT, 10mm, 8.8, PLT
2	1	EACH	PUL89022	PULLEY, CRANK, ISL, 8.9L, 2B/X, 8", '13
1	5	EACH	BTCT0050	BOLT, HEX, 10 x 1.5 x 50mm, 10.9, PLT

**TRANSARCTIC INC.**

UNSPECIFIED TOLERANCES:	ALL DIM.
ONE DECIMAL PLACE (X.0)	±0.10 (±.004)
TWO DECIMAL PLACE (X.00)	±0.02 (±.0008)
THREE DECIMAL PLACE (X.000)	±0.002 (±.00008)
FRACTIONAL (1/16")	±.005 (±.0002)

DRAWN	DATE	TITLE
J Rodriguez	10/15/2013	
Checked		
val Jakowlew	10/15/2013	
GA		
James Stewart	10/15/2013	
MFG		
Ron Ingram	10/15/2013	
APPROVED		
Dale Mason	10/15/2013	

REV	DESCRIPTION	DATE	BY
0	RELEASED TO PRODUCTION	10/15/2013	JRB

THIS DRAWING CONTAINS PROPRIETARY CONFIDENTIAL INFORMATION OWNED BY TRANSARCTIC CANADA INC. THE DOCUMENT AND THE INFORMATION IN IT ARE NOT TO BE USED, DISCLOSED OR REPRODUCED WITHOUT EXPRESS WRITTEN PERMISSION OF THE COMPANY.

THIRD ANGLE PROJECTION

SIZE	DWG NO	REV
D	KPC89022	0

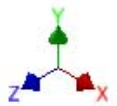
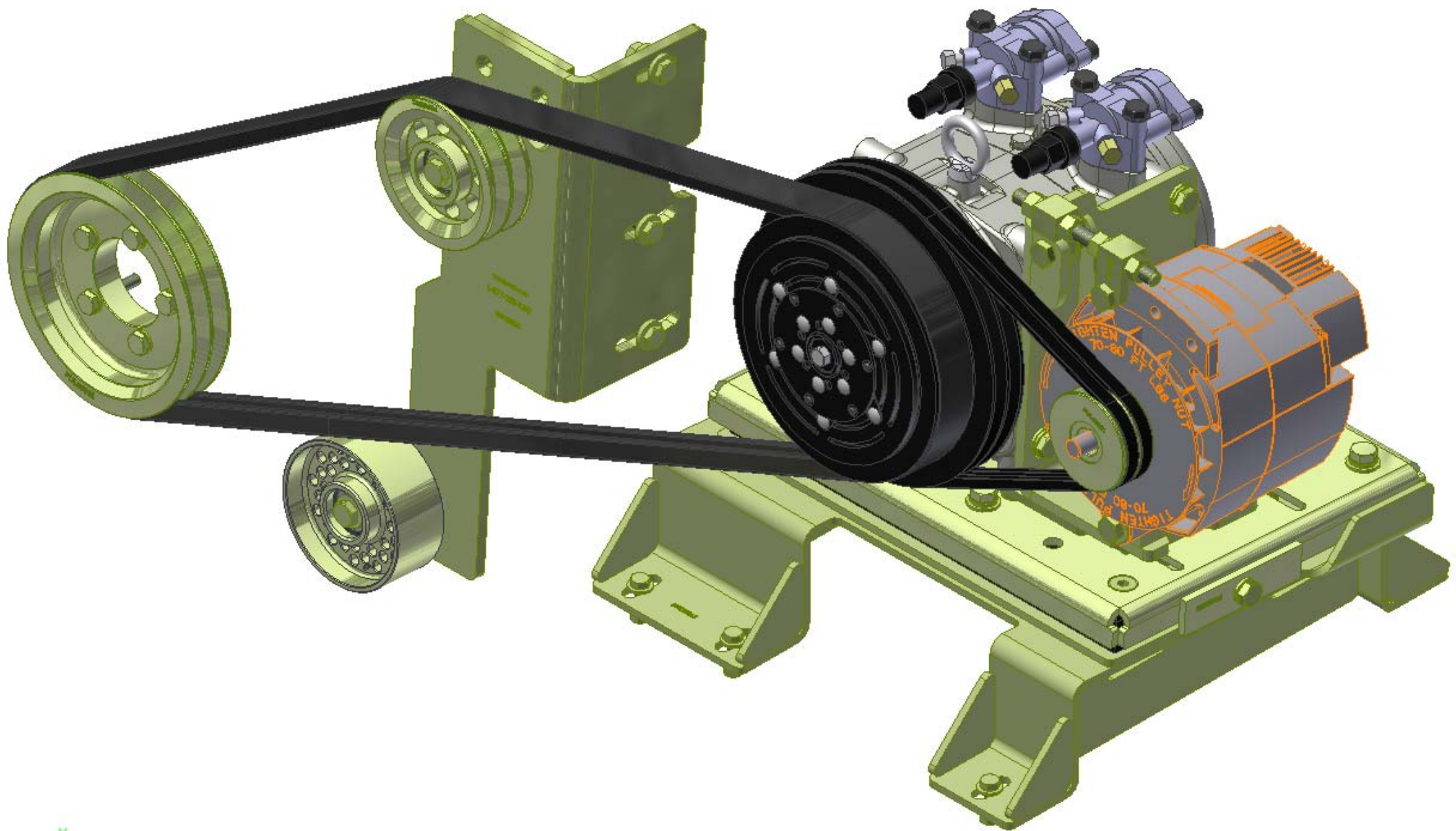

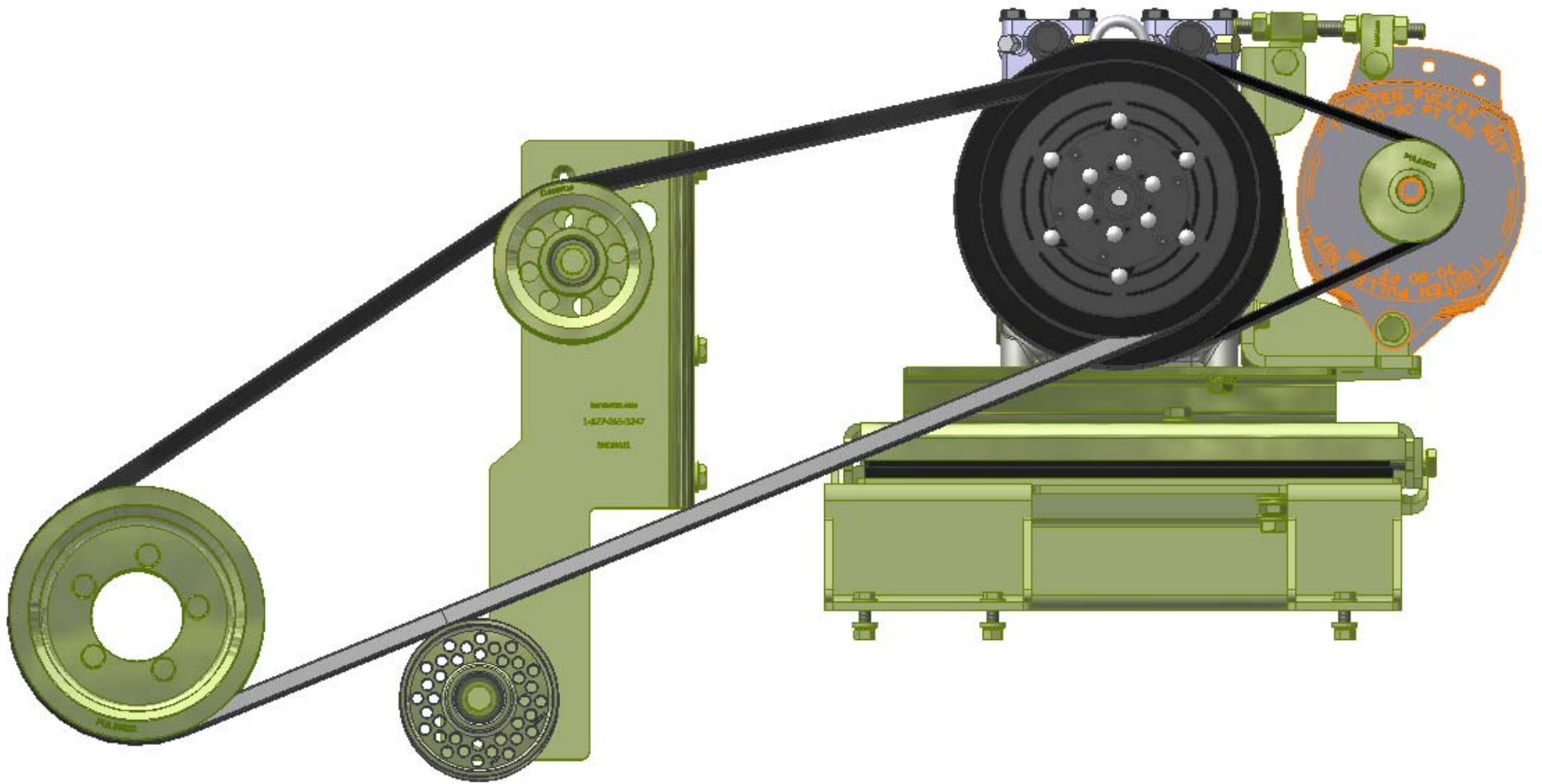



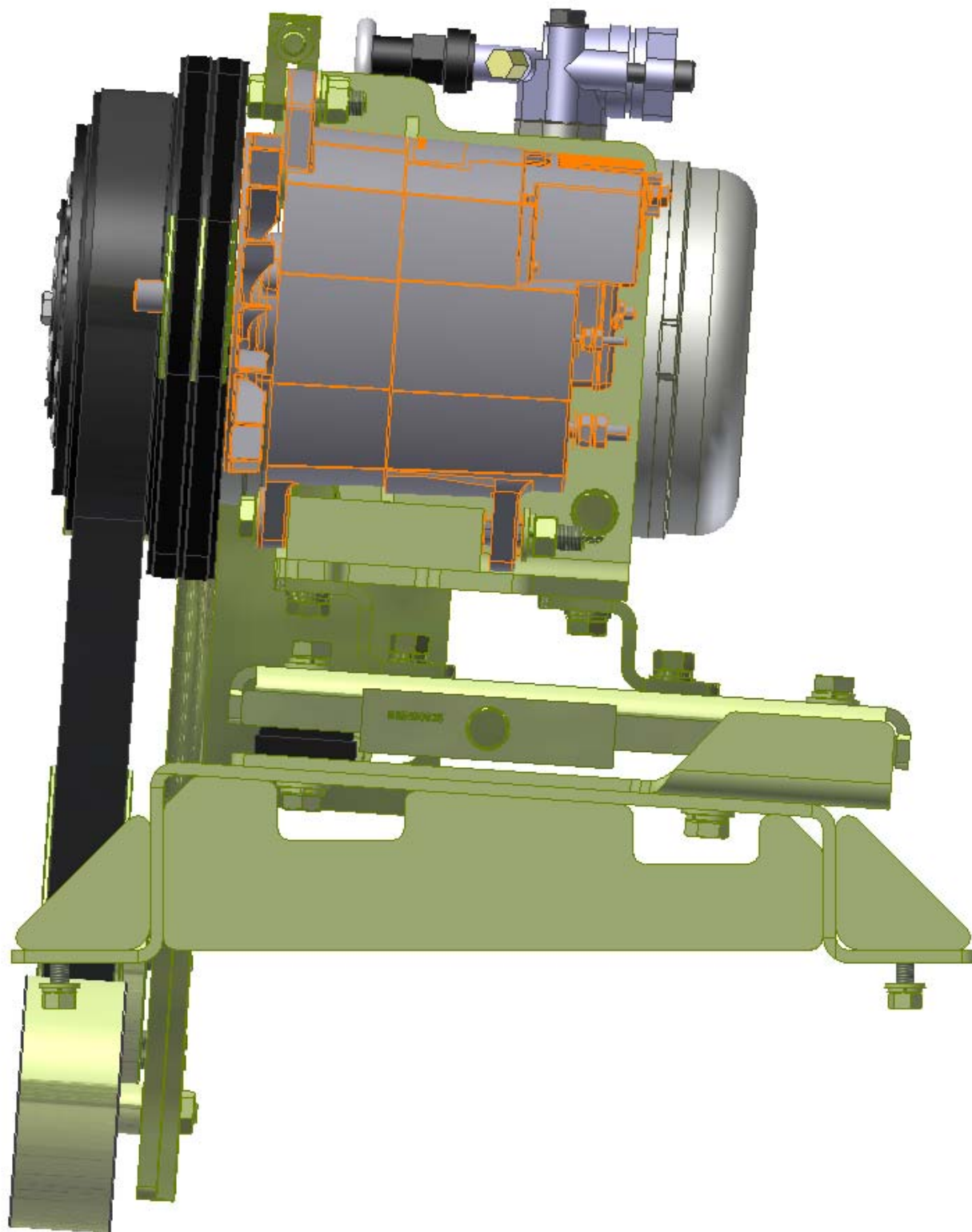

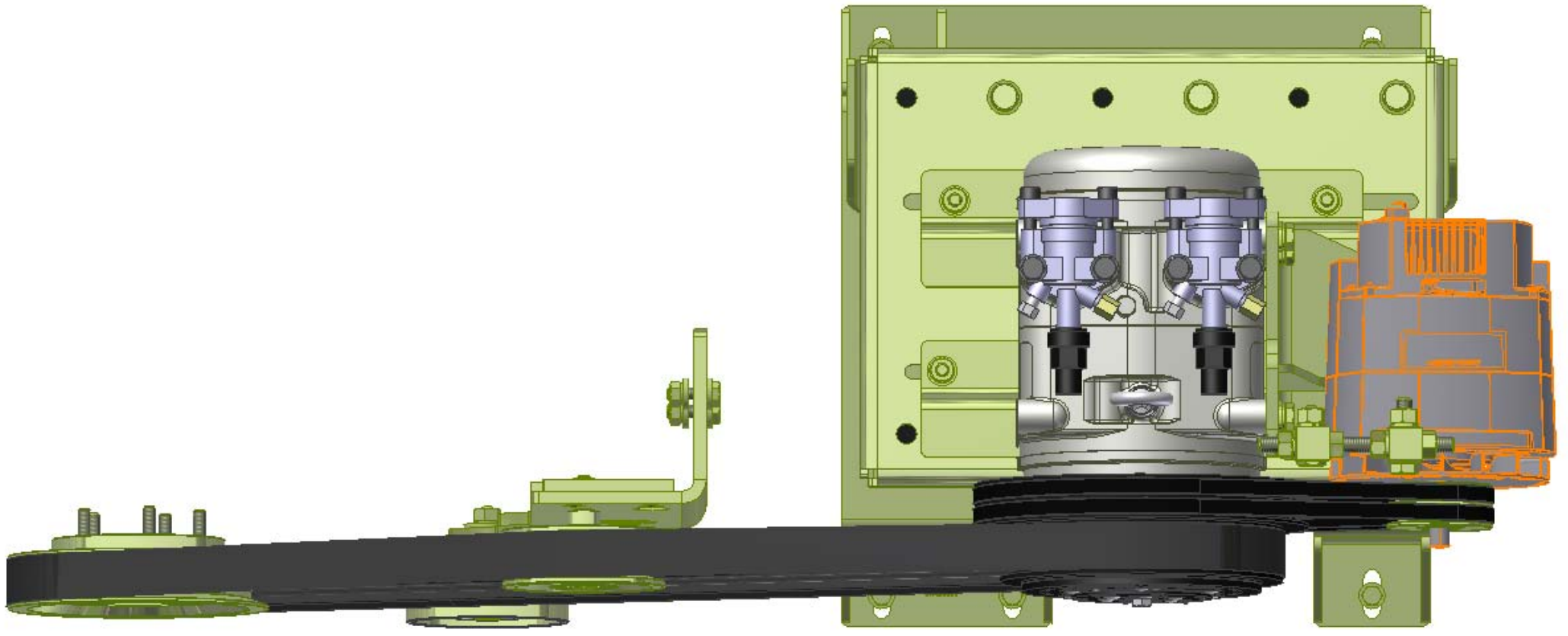

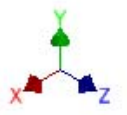
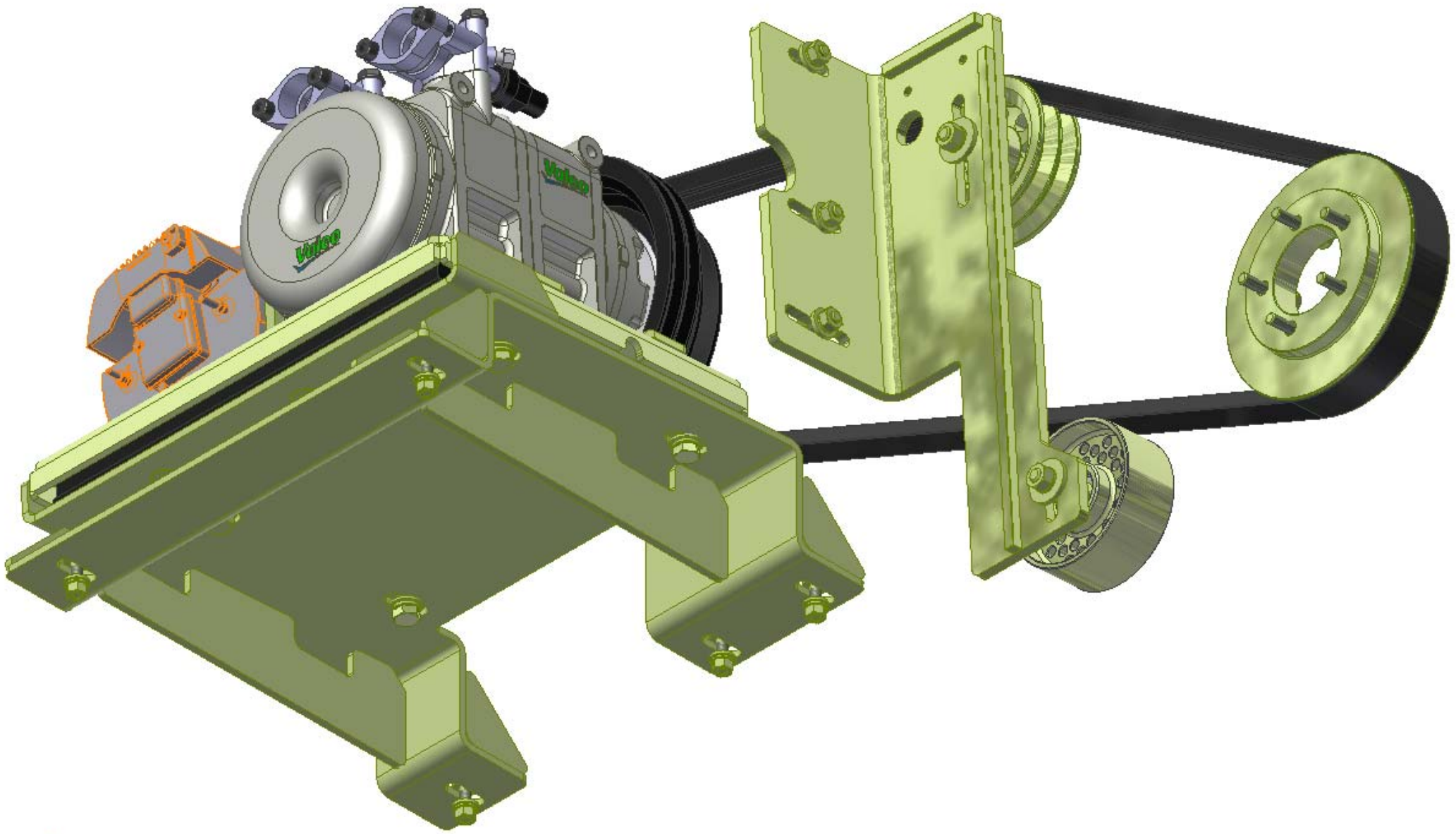

## **TransArctic A/C Compressor Mount Installation Disclaimer**

All compressor mounts should be installed by qualified and trained personnel using proper tools and equipment in safe working conditions following industry standard guidelines for motor vehicle service and repair.

The installer of any compressor mount purchased from TransArctic must undertake all responsibility of issues arising from that compressor bracket being installed on any vehicle. As well as insure that a **proper and sufficient ground** is established between the compressors' clutches and the vehicle's engine. Mount functionality, operation and durability can all be compromised by an incompetent installation.

Due to the many different situations, parameters and application criteria, which are beyond the compressor mount manufacturer's control, TransArctic does not warrant design, durability, or operational functionality of any compressor mount improperly installed by another party.

**With no implied guarantees it is the mount installer's strict responsibility to determine safety and functionality, of the compressor mount, at the time of installation.**

Please contact TransArctic with any issue arising from installation so we may better improve the product. If you have any reservations about the compressor mount integrity contact TransArctic immediately at 1-877-COLD-AIR.

**Mark OEM tensioner location**

**Install Kit**

**Check for Interferences**

**Check to ensure that the proper OEM tensioner orientation is maintained**

**Run engine with A/C system engaged for at least 10 minutes to run in belt**

**Check OEM tensioner orientation and adjust as required**

### **Responsabilidad limitada de TransArctic en la instalación del soporte del compresor**

Todos los soportes de los compresores deben ser instalados por personas calificadas y entrenadas, usando para ello los equipos y herramientas necesarios para esta labor en buenas condiciones y según las normas y guías para el servicio y/o reparación de motores de vehículos.

El instalador de los soportes comprados en TransArctic asume toda la responsabilidad de cualquier problema que surga en el soporte del compresor al vehículo; de igual manera es responsable que el cable a tierra sea conectado entre el embrague del compresor y el motor del vehículo.

Se advierte que el buen funcionamiento y la durabilidad del soporte pueden ser comprometidos por defectos en su instalación.

Debido a las diversas situaciones que se puedan presentar fuera del control del fabricante, TransArctic no garantiza el diseño, la durabilidad o el correcto funcionamiento de cualquier equipo inapropiadamente instalado por terceros.

**Esta sobreentendido que el Instalador del montaje del compresor es estrictamente responsable de la seguridad y funcionamiento del equipo en el momento de la instalación.**

Si tuviera algún problema o duda acerca de la instalación del soporte del compresor pongase en contacto inmediatamente con TransArctic al teléfono 1-877-COLD-AIR de modo que podamos mejorar nuestro producto.

**Note la ubicación del medidor de tensión OEM**

**Instale el equipo**

**Controlar si hay interferencias.**

**Asegurese que el medidor de tensión mantenga la orientación justa.**

**Encienda el motor por lo menos 10 minutos con el sistema A/C enganchado para que la correa corra**

**Controle la orientación justa del medidor de tensión y ajuste a las condiciones requeridas del fabricante**